



# The **SIGN** Catalogue

Your comprehensive signage directory

# Legislation and Guidance

The Health and Safety (Safety Signs and Signals) Regulations 1996 require employers to provide and maintain safety signs where there is significant risk to health and safety that has not been avoided or controlled by other means (e.g. safe systems of work) provided that the use of a sign can help reduce the risk.

Throughout this catalogue you will find guidance about;

- ▶ Risk assessment
- ▶ Use of pictorial symbols
- ▶ General health and safety signs
- ▶ Fire/emergency escape signs
- ▶ Positioning of signs
- ▶ Marking of hazardous storage areas and obstacles
- ▶ Dangerous locations
- ▶ Identification of pipelines

ISO 7010 is the International standard for safety signs.

ISO 7010 was developed to provide consistency in design across the EU. Stocksigns has incorporated the new designs and you may notice some design changes to the symbols whereas others are virtually unchanged.

The majority of British Standard symbols have been adopted by ISO and as such have now been encompassed into UK safety legislation.

## Use of Symbols and Graphical Images

The use of symbols and graphical images is a simple safety system used to convey safety messages at a glance. Colours and symbols, appropriately used, provide information and warnings of hazards which are essential to personal safety.

### Prohibition



A red circular band with diagonal cross bar on a white background, the symbol within the circle to be black denoting a safety sign that indicates that a certain behaviour is prohibited.

### Hazard



A yellow triangle with black border and symbol within the yellow area denoting a safety sign that gives warning of a hazard.

### Mandatory



A blue circle with white symbol denoting a sign that indicates that a specific course of action must be taken.

### Fire Equipment



A red rectangle or square with symbol in white denoting a safety sign that indicates the location of fire fighting equipment.

### Safe Condition



A green rectangle or square with symbol or text in white denoting a safety sign providing information about safe conditions.

## LOOK OUT FOR



**Best Sellers**  
The best selling signs and products.



**New**  
Signs and ranges new to this catalogue.



**Updated**  
Signs updated to the latest ISO 2018 symbols.



**Great Value**  
Products that represent excellent value for money.



## Stocksigns Accreditations and Associations



# Our Services



## Professional Site Survey

**At Stocksigns we pride ourselves on our experience across many industries. We've successfully managed projects from airports and quarries, to schools and commercial premises.**

We have experience with an extensive range of materials from vinyl graphics, through to large illuminated monoliths and everything in between.

If you are embarking on a project and need professional help and support, our site survey specialists are available to help. They can offer advice and expertise to ensure the wayfinding, health and safety and corporate branding in your workplace are legislation compliant and reflective of your company and brand.

## Installation

**Alongside our professional surveyors, Stocksigns have a dedicated team of fitters and installation experts.**

The team operate throughout the UK and over our long history we have experience of installing everything from single signs to managing large scale installation projects.

We recognise the importance of working safely on-site and Stocksigns are proud to be accredited members of the SafeContractor scheme. This accreditation demonstrates that we operate under recognised high health and safety standards.

In addition, all our installation crews are CSCS (Construction Skills Certification Scheme) certified, Asbestos Trained in line with UKATA, certified by UPAF standards to operate Mobile Evaluating Work Platforms and hold current First Aid certificates.



## Delivery Services



Orders for stocked standard signs will be despatched next day and will take between 2-3 days for delivery. Custom made orders will be despatched within 5 working days from receipt of order.

If you require these signs urgently, you may wish to use our premium service, where your signs will be despatched as priority. Please speak to the sales team regarding this service.

### Export

Worldwide despatch is no problem. Our Export Sales Team is happy to provide quotations for any quantity of signs for any country.

### Collection

At our Trade Counter in Redhill, signs can be purchased and/or collected between 8.30am and 5.00pm Monday - Friday.

### Delivery Costs

The charge for packing, delivery and insurance to most UK mainland postcodes is FREE for standard orders over £50.

#### Standard Product Delivery Charges

- ▶ Orders under £20 (Depending on size and weight) - **£1.95**
- ▶ Orders up to £49.00 (Depending on size and weight) - **£6.75**
- ▶ Orders over £50.00 - **FREE**

#### Custom-made Signs Delivery Charges

- ▶ Orders less than 10kgs - **£7.50**
- ▶ Orders 10 - 20 kgs - **£13.50**
- ▶ Orders 20 - 50 kgs - **£25.00**
- ▶ Orders over 50kgs - **POA**

For **Premium Service** delivery rates, export, Scottish Highlands and off-shore locations, please contact our Sales Team on 01737 774077 for prices.

# Glass Door Marking

## Glass Highlighting

These individual symbols are supplied in strips and with an adhesive back. Size of strip is approximately 500mm long and 150mm high.

Price per strip [£21.26](#)

Call our Sales Team on 01737 774077 for details on Custom-made highlighting designs.

### DO YOU COMPLY?

Regulation 14 of the Workplace (Health, Safety and Welfare) Regulations 1992 requires the marking of windows and glass doors to make them conspicuous.



Spray the application surface with water plus a little detergent



Remove the backing paper, keeping the sticker flat

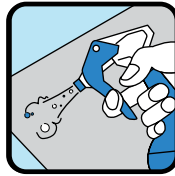

Spray the adhesive surface with water plus a little detergent

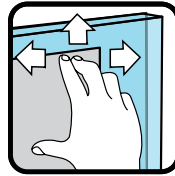

Apply sticker to wet surface and bring into position



Secure the sticker to the surface with a squeegee with firm pressure



60 26865



60 26067



60 21092



60 21091

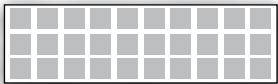

60 21093



60 03055



60 03065



60 03061



60 03056



60 03066



60 21090



60 03057



60 03067



60 03068



60 03058



60 03071



60 03062



60 03059



60 03069



60 03072



60 03060



60 03070



60 03063



60 03073



60 03074



60 03075



60 03076



60 03077



60 03078



60 03079



60 03080



60 03081



60 03082



60 03083



60 03091



60 66066

## Vinyl Window Stickers

Stocksigns can create a range of vinyl and static stick window stickers particularly suitable for the retail environment. These can incorporate any logo, branding or promotional messaging and can be printed to fit any shop frontage. Please call the Sales Team on 01737 774077 for full details.



## Social Media Icons

Vinyls are an effective way to promote your social media sites. Shown here are a selection of the designs we can provide. Please speak to our Sales Team on 01737 774077 for more information and prices.



## 16 swg Anodised Aluminium

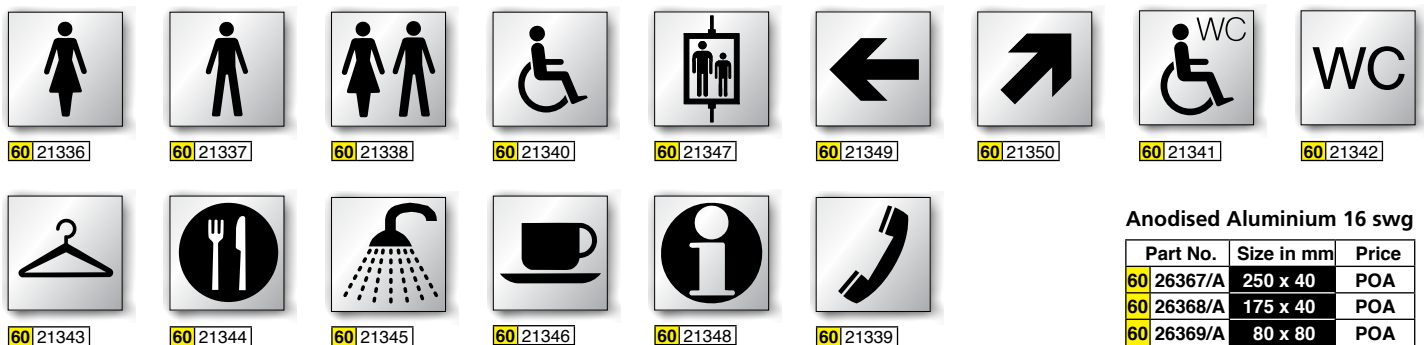

Anodised Aluminium 16 swg		
Part No.	Size in mm	Price
60 26367/A	250 x 40	POA
60 26368/A	175 x 40	POA
60 26369/A	80 x 80	POA