

DELTA®-DRAIN

Safety for permanently dry foundation walls.

Two-way dimpled sheet with extra large drainage capacity.



- Protection and drainage system for compression-resistant surfaces
- For earth-boundary construction elements
- For vertical and horizontal application

Foundation-wall protection and drainage in a single product? That's DELTA® for you.



■ DELTA®-DRAIN

There is a permanent risk associated with all earth-boundary construction elements, such as foundation walls: They may easily become damp. This is why safe damp-proofing is of such outstanding importance in this context: DELTA®-DRAIN provides reliable surface drainage for cellar and retaining walls as well as roof gardens by filtering out fine-grained soil particles, ensuring constant water drainage, and permanently protecting foundation walls.

■ DELTA®-Accessories

Why not use the advantages of the comprehensive range of DELTA®-Accessories: DELTA®-NOPPENBAHNEN-PROFIL, DELTA®-HAFTNAGEL, DELTA®-MS DÜBEL and DELTA®-MS KNOPF.

Crucial Advantages Quickly Pay for Themselves:

DELTA®-DRAIN

High Compression Strength. Ov

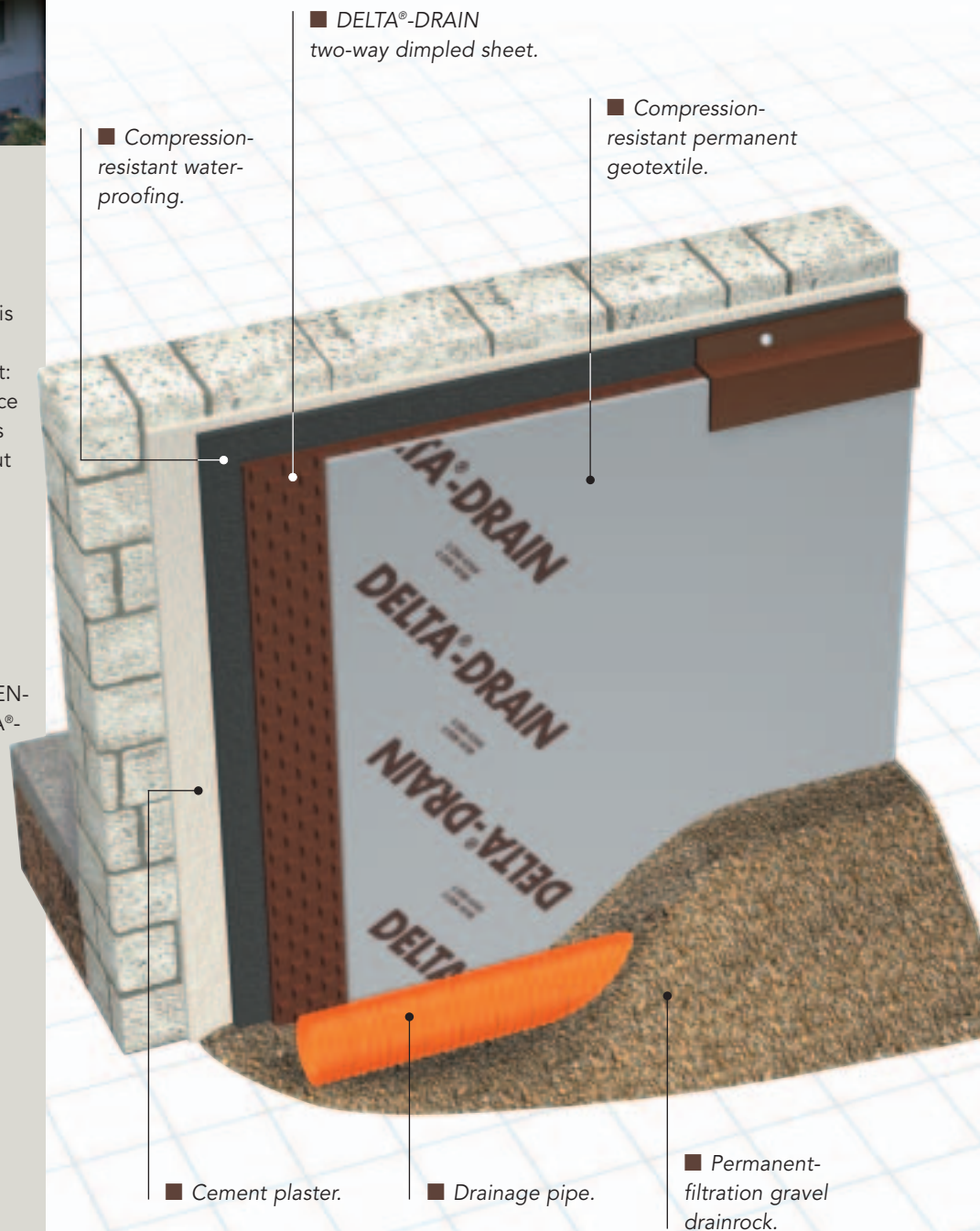

STANDARD QUALITY

DELTA® quality branded products made by Dörken.



Dependable surface drainage for retaining walls.

Edge overlap of dimpled sheet and geotextile.

DELTA®-MS Dübel for easy attachment.

over 50 % Elongation at Break.

DELTA®-DRAIN ...

- ... is a protection and drainage system for compression-resistant surfaces.
- ... is a two-way dimpled sheet made from special high-density PE with a fused-on PP geotextile. A compact system that may be applied quickly straight from the roll.
- ... is made exclusively of branded polyethylene. Containing no recycled material, it is itself fully recyclable.
- ... resists degradation in soil and is non-polluting for drinking water.
- ... forms a system of ventilation ducts between the foundation wall and the dimples which keeps the wall dry and provides additional heat insulation.
- ... features a drainage capacity that can handle twice the maximum amount of water that is likely to occur under unfavourable soil conditions.
- ... is highly compression-resistant.
- ... can be easily laid around corners and projections thanks to its elongation at break of more than 50 %.



DELTA®-DRAIN keeps foundation walls dry and provides additional heat insulation.

- ... conforms to DIN 18 195, DIN 4095, and Eco-standard 2209.
- ... features a material life of no less than 25 years when installed.



Why not profit from the DELTA® System?

2 layers – one complete system:

Layer 1: The two-way dimpled sheet. Featuring dimples on both sides, it offers two advantages: On the one hand, the dimples between the foundation wall and the sheet create a system of ventilation ducts which keeps the foundation wall permanently dry. On the other hand, the dimples that point towards the surrounding soil provide

drainage across the entire surface.

Layer 2: The compression-resistant permanent geotextile made of PP. Laminated on to the dimpled sheet, the layer of rot-proof geotextile out fine-grained soil particles, thus protecting the system of ducts formed by the dimples from being clogged up by sludge. This permits water to flow unhindered downwards to the perforated drainage pipe.

Needless to say, we have a range of perfect accessories, of which you find additional information on the next page.

DELTA®-DRAIN

Technical Data Overview:

Dimpled sheet material	HDPE
Geotextile material	Polypropylene
Compressive strength	approx. 90 kN/m ² , conforming with DIN 53 454
Dimple height	approx. 12 mm
Drainage capacity	approx. 1.2 l/sec · m when compressed by 13% (corresponding to an installation depth of about 2.5 m)
Roll size	12.5 m x 2 m

DELTA®-Accessories for DELTA®-DRAIN.

Dörken makes your life easier – systematically.

You are sure to appreciate these handy DELTA®-Accessories:



DELTA®-NOPPEN-BAHNEN-PROFIL
Edge sealing strip.

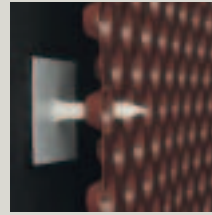

DELTA®-HAFTNAGEL
Self-adhesive pin aids installation.

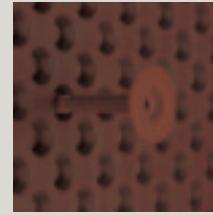

DELTA®-MS DÜBEL
Plastic wall plug for sheet attachment.

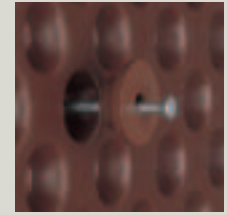

DELTA®-MS KNOPF
Washer which keeps the material from tearing during attachment.

DELTA® is a registered trademark of Ewald Dörken AG, Herdecke, Germany.

DELTA®



DELTA® System ...

... for owners:

" ... What I get is a mature problem solution provided at a fair price by the top specialist in quality branded products!"

... for workers:

" ... What I get is a complete system made by a single manufacturer that enables me to do anything to the owner's entire satisfaction. There is no safer way!"

... for planners:

" ... I can be certain that both innovative and standard products will be used in implementing my roof and cellar plans in a systematic and forward-looking way."



Dörken GmbH & Co. KG
Wetterstraße 58
D-58313 Herdecke
Tel.: +49 (0) 23 30/63-0
Fax: +49 (0) 23 30/63-355
bvf@doerken.de
www.doerken.de

A company of the Dörken Group.

Delta Membrane Systems Ltd.
Delta House, Merlin Way
North Weald, Epping,
Essex CM16 6HR
Tel.: +44 (0)1992 523 523
Fax: +44 (0)1992 523 250
info@deltamembranes.com
www.deltamembranes.com

