



aquatecnic
wetroom systems



• aquaproof
tanking system

aquatecnic's aquaproof

Aquaproof System

The Aquaproof System has been developed specifically to prevent water leakage from tiled areas, including wetrooms, shower areas, bathrooms and kitchens.

Aquaproof system is compatible with a wide range of substrates, including ply sheeting, shower tray formers, plasterboard, MDF, cementitious screed and most commonly available waterproof construction boards.

The applied Aquaproof System can tolerate normal levels of movement in a room and does not become brittle with age.



Aquaproof System is technically advanced and comes with a 10 year manufacturers warranty; it also meets the requirements of the new European Technical Approval ETA-08/0250 "Liquid applied watertight coverings for wetrooms with wearing surface"

By specifying Aquaproof a fully tanked room will be achieved, preventing damage to walls/floors and leakage into adjacent rooms.

Aquaproof is:

- ✓ Fully Waterproof
- ✓ Breathable (water vapour permeable)
- ✓ Flexible
- ✓ Easy to tile with standard waterproof tile adhesives
- ✓ Simple to apply
- ✓ Silicone compatible
- ✓ Compatible with underfloor heating
- ✓ User friendly (virtually odour free)

● **We're Here to Help** | If you need any further advice please do not hesitate to contact us.

How to install the Aquaproof Tanking System



1. Apply Primer



2. Apply Tape

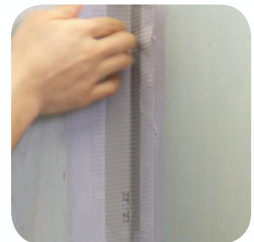

3. Apply Pre-formed Corners (internal or external)



4. Apply Pipe Sleeves

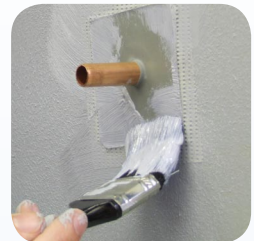

5. Unscrew the top of the trap and clamping ring

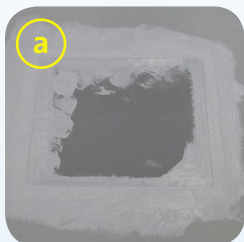

a. Brush on compound and lay outlet sleeve on top

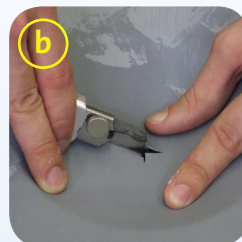

b. When dry, cut an 'x' with a knife in the centre



c. Push down on clamping ring and mark screw holes

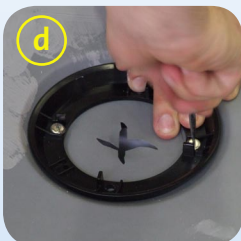

d. Secure the clamping ring with screws



e. Cut away the excess sleeve inside the ring



6. Finish by applying 2-3 coats of Compound over the entire area



Aquaproof Tanking System | The Complete Wetroom Solution



Aquaproof System is made up of the following products:

- **Aquaproof Primer**
Solvent free, SBR based primer for all absorbent surfaces. Usage rate approx. 150g / sq.m.
- **Aquaproof Tape**
Fabric reinforced, elastic sealing tape for wall/floor junctions and other areas subject to stress.
- **Aquaproof Compound**
Solvent free, sealing membrane supplied as a thick paste. Applied in 2-3 coats to give a 1mm thick, robust and elastic rubber membrane. Usage rate approx. 900g / sq.m.
- **Aquaproof Pre-formed Corners**
Internal and external corners can be formed with Aquaproof Tape but for ease of use and extra security we recommend the use of our pre-formed 90 degree internal and external corners.
- **Aquaproof Pipe Sleeves**
Pipe Sleeves are supplied 115mm x 115mm with an 8mm hole in the middle, these are simply stretched over pipe penetrations to create a seal.
- **Aquaproof Outlet Sleeves**
Outlet Sleeves are supplied 350mm x 350mm with a fabric border, they are ideal for sealing under the clamping ring of wet-floor waste outlets or around larger penetrations such as 100mm waste pipes.
- **Aquaproof Shower Kit**
Contains all the material that you need for a small to medium size wetroom. Contents 2kg Aquaproof Primer, 9kg Aquaproof Compound, 15 lin.m. Aquaproof Tape, 2 x Aquaproof Pipe Sleeves, 1 x Aquaproof Outlet Sleeve.

The material included is sufficient to waterproof a surface area of up to 10sq.m. Extra material and pre-formed corners may be ordered in conjunction with the shower kit.

aquatecnic
wetroom systems

Distributed by:
DELTA Membrane Systems Ltd.

Telephone: 01992 523523
Fax: 01992 523250
Email: info@deltamembranes.com
Web: www.deltamembranes.com