

BRASS HI-BAR® FLANGE MOUNT SAFETY SCREENS

The Lee Company now offers a complete line of flange mount, HI-BAR® Safety Screens made entirely of brass, per ASTM B16/B16M. These screens combine a high strength design with a material that has a high resistance to ignition and combustion, as well as excellent corrosion resistance. Depending on size, their robust, single piece construction enables these screens to withstand fully clogged pressure differentials of 1000 psid to 4500 psid without rupture.

Since brass is less likely to ignite or burn than aluminum or stainless steel, it is generally considered a superior material for use in oxygen applications. Due to its low propensity for sparking, it is also well suited for use in explosive gas environments.

- Rugged, One Piece Design Made Entirely of Brass
- Exceptional Resistance to Ignition/Combustion
- Burst/Collapse Pressure: 1000 psid to 4500 psid
- 48 Standard Versions for Design Flexibility
- Hole Sizes from 0.002" to 0.020"
- Custom Designs Available



These Brass HI-BAR Safety Screens are available in 6 different flange sizes ranging from 0.130" to 0.670" in diameter, and 8 different hole sizes ranging from 0.002" to 0.020" in diameter. All Lee Safety Screens are precision cleaned and packaged before

shipment. Special designs are available upon request. Contact your local Lee Sales Engineer for additional information or technical assistance.

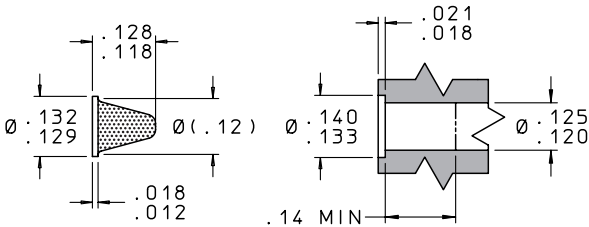

130 FLANGE MOUNT SCREEN

LEE PART NUMBER	HOLE SIZE (in.)	HOLE SIZE (µm)	OPEN AREA (in. ²)	TOTAL AREA (in. ²)	NUMBER OF HOLES	BURST / COLLAPSE PRESSURE (psid min.)	Rob** NUMBER	LOHM* RATE (nom.)
FSHF1303005A	0.002	50	0.002	0.02	630	4500	0.06	500
FSHF1303007A	0.003	75	0.002	0.02	370	4500	0.14	350
FSHF1303010A	0.004	100	0.003	0.02	200	4500	0.2	350
FSHF1303015A	0.006	150	0.003	0.02	110	4500	0.6	350
FSHF1303020A	0.008	200	0.003	0.02	45	4500	0.8	300
FSHF1303025A	0.010	250	0.003	0.02	40	4500	1.8	300
FSHF1303040A	0.015	380	0.004	0.02	25	4500	7.3	250
FSHF1303050A	0.020	500	0.005	0.02	14	4500	16.7	200

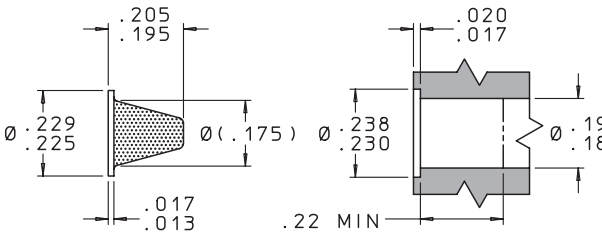

230 FLANGE MOUNT SCREEN

LEE PART NUMBER	HOLE SIZE (in.)	HOLE SIZE (µm)	OPEN AREA (in. ²)	TOTAL AREA (in. ²)	NUMBER OF HOLES	BURST / COLLAPSE PRESSURE (psid min.)	Rob** NUMBER	LOHM* RATE (nom.)
FSHF2303005A	0.002	50	0.006	0.06	1810	3000	0.2	200
FSHF2303007A	0.003	75	0.007	0.06	990	3000	0.4	120
FSHF2303010A	0.004	100	0.010	0.06	795	3000	0.8	95
FSHF2303015A	0.006	150	0.010	0.06	350	3000	1.8	95
FSHF2303020A	0.008	200	0.010	0.06	200	3000	3.4	95
FSHF2303025A	0.010	250	0.010	0.06	130	3000	6.0	95
FSHF2303040A	0.015	380	0.013	0.06	70	3000	20	90
FSHF2303050A	0.020	500	0.013	0.06	42	3000	49	90

BRASS HI-BAR® FLANGE MOUNT SAFETY SCREENS

330 FLANGE MOUNT SCREEN

LEE PART NUMBER	HOLE SIZE (in.)	HOLE SIZE (µm)	OPEN AREA (in. ²)	TOTAL AREA (in. ²)	NUMBER OF HOLES	BURST / COLLAPSE PRESSURE (psid min.)	ROB** NUMBER	LOHM* RATE (nom.)
FSHF3303005A	0.002	50	0.012	0.12	3820	2200	0.4	65
FSHF3303007A	0.003	75	0.016	0.12	2260	2200	0.8	55
FSHF3303010A	0.004	100	0.022	0.12	1750	2200	1.9	50
FSHF3303015A	0.006	150	0.022	0.12	778	2200	4.0	45
FSHF3303020A	0.008	200	0.022	0.12	435	2200	7.4	45
FSHF3303025A	0.010	250	0.022	0.12	280	2200	13	45
FSHF3303040A	0.015	380	0.028	0.12	158	2200	46	45
FSHF3303050A	0.020	500	0.028	0.12	90	2200	107	40

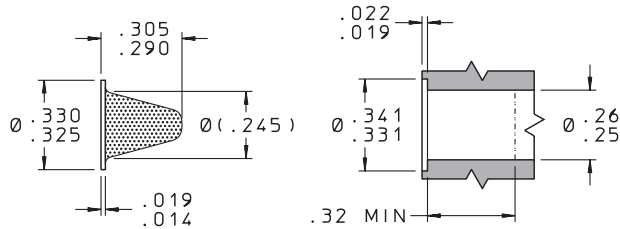

380 FLANGE MOUNT SCREEN

LEE PART NUMBER	HOLE SIZE (in.)	HOLE SIZE (µm)	OPEN AREA (in. ²)	TOTAL AREA (in. ²)	NUMBER OF HOLES	BURST / COLLAPSE PRESSURE (psid min.)	ROB** NUMBER	LOHM* RATE (nom.)
FSHF3803005A	0.002	50	0.017	0.17	5415	1600	0.5	55
FSHF3803007A	0.003	75	0.022	0.17	3110	1600	1.2	45
FSHF3803010A	0.004	100	0.031	0.17	2465	1600	2.6	35
FSHF3803015A	0.006	150	0.031	0.17	1095	1600	5.6	30
FSHF3803020A	0.008	200	0.031	0.17	616	1600	10	30
FSHF3803025A	0.010	250	0.031	0.17	395	1600	18	30
FSHF3803040A	0.015	380	0.038	0.17	245	1600	71	30
FSHF3803050A	0.020	500	0.038	0.17	120	1600	143	30

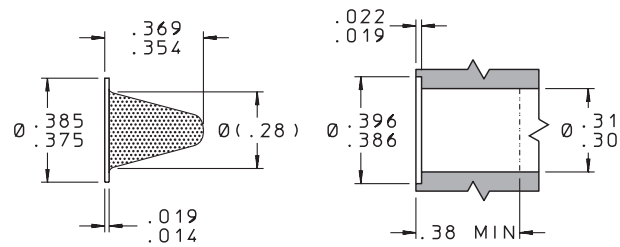

495 FLANGE MOUNT SCREEN

LEE PART NUMBER	HOLE SIZE (in.)	HOLE SIZE (µm)	OPEN AREA (in. ²)	TOTAL AREA (in. ²)	NUMBER OF HOLES	BURST / COLLAPSE PRESSURE (psid min.)	ROB** NUMBER	LOHM* RATE (nom.)
FSHF4953005A	0.002	50	0.03	0.32	10 200	1000	1.0	25
FSHF4953007A	0.003	75	0.04	0.32	5660	1000	2.1	25
FSHF4953010A	0.004	100	0.06	0.32	4775	1000	5.1	20
FSHF4953015A	0.006	150	0.06	0.32	2120	1000	11	20
FSHF4953020A	0.008	200	0.06	0.32	1190	1000	20	20
FSHF4953025A	0.010	250	0.06	0.32	765	1000	34	20
FSHF4953040A	0.015	380	0.07	0.32	395	1000	115	20
FSHF4953050A	0.020	500	0.07	0.32	225	1000	268	20

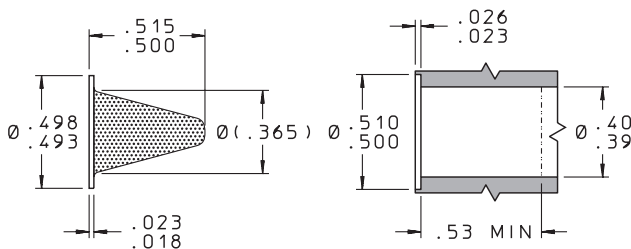

670 FLANGE MOUNT SCREEN

LEE PART NUMBER	HOLE SIZE (in.)	HOLE SIZE (µm)	OPEN AREA (in. ²)	TOTAL AREA (in. ²)	NUMBER OF HOLES	BURST / COLLAPSE PRESSURE (psid min.)	ROB** NUMBER	LOHM* RATE (nom.)
FSHF6703005A	0.002	50	0.06	0.62	19 750	1000	1.9	15
FSHF6703007A	0.003	75	0.08	0.62	11 315	1000	4.2	15
FSHF6703010A	0.004	100	0.11	0.62	8755	1000	9.3	10
FSHF6703015A	0.006	150	0.11	0.62	3890	1000	20	10
FSHF6703020A	0.008	200	0.11	0.62	2190	1000	37	10
FSHF6703025A	0.010	250	0.11	0.62	1400	1000	63	10
FSHF6703040A	0.015	380	0.14	0.62	790	1000	230	10
FSHF6703050A	0.020	500	0.14	0.62	445	1000	530	10

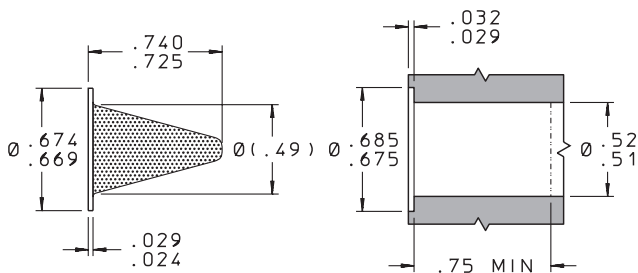

* The Lohm is a measure of flow resistance. Example: One Lohm will permit a flow of 100 GPM of water at 25 psid at 80°F.

** The ROB Number indicates the relative resistance to blockage when comparing one screen to another. The higher the ROB Number, the greater the resistance to blockage.

Additional information can be found at www.theleeco.com or by contacting your local Lee Sales Engineer.