

HIGH PRESSURE FLANGE MOUNT ETCHED SAFETY SCREENS

The Lee Company has expanded the etched screen product line with the introduction of High Pressure 17-7PH Flange Mount Safety Screens. These new screens take advantage of the higher strength material properties of 17-7PH stainless steel to provide burst and collapse pressures which average more than 2 times those of the existing 304L designs. The 17-7PH screens are completely interchangeable with the existing etched, flange mount product line, and use the same field-proven configuration to provide maximum open screen area for increased dirt holding capacity.

The 17-7PH Flange Mount Safety Screens are available in 7 different flange sizes

- Rugged, 17-7PH CRES and Gold Braze Construction
- 28 Standard Versions for Design Flexibility
- Maximum Open Screen Area
- Nominal Weight: 0.05 to 3.1 grams
- Field-proven Construction
- Hole Sizes from 0.004" to 0.015"



ranging from 0.130" to 0.656" in diameter. In addition, standard screen hole sizes include 0.004", 0.006", 0.008" and 0.015".

Special designs are available upon request. Contact your Lee Sales Engineer for additional information or technical assistance.

130 FLANGE MOUNT SCREEN

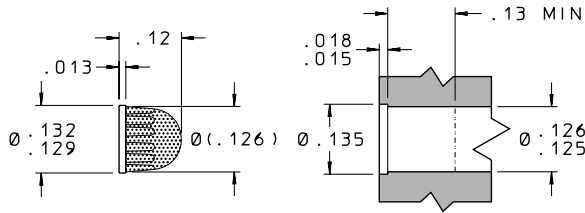

Lee Part Numbers	Hole Size in.	Open Area in.²	Total Area in.²	No. of Holes	Burst Press. psid	Collapse Press. psid	ROB† No.	Lohm†† Rate
FSJA1300047A	.004	.019	.062	1500	3750	1350	1.6	250
FSJA1300067A	.006	.020	.062	700	4600	3500	3.6	250
FSJA1300087A	.008	.014	.062	250	7100	3500	4.2	250
FSJA1300157A	.015	.026	.062	150	7000	4550	44	250

170 FLANGE MOUNT SCREEN

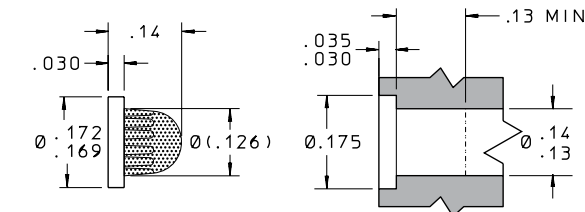

Lee Part Numbers	Hole Size in.	Open Area in.²	Total Area in.²	No. of Holes	Burst Press. psid	Collapse Press. psid	ROB† No.	Lohm†† Rate
FSJA1700047A	.004	.019	.062	1500	3750	1350	1.6	250
FSJA1700067A	.006	.020	.062	700	4600	3500	3.6	250
FSJA1700087A	.008	.014	.062	250	7100	3500	4.2	250
FSJA1700157A	.015	.026	.062	150	7000	4550	44	250

230 FLANGE MOUNT SCREEN

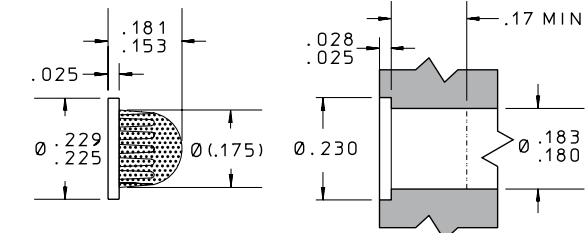

Lee Part Numbers	Hole Size in.	Open Area in.²	Total Area in.²	No. of Holes	Burst Press. psid	Collapse Press. psid	ROB† No.	Lohm†† Rate
FSJA2300047A	.004	.029	.098	2330	2050	850	2.5	95
FSJA2300067A	.006	.032	.098	1130	3600	1600	5.8	95
FSJA2300087A	.008	.024	.098	480	3850	1700	8.1	95
FSJA2300157A	.015	.042	.098	240	3300	1700	70	95

HIGH PRESSURE FLANGE MOUNT ETCHED SAFETY SCREENS

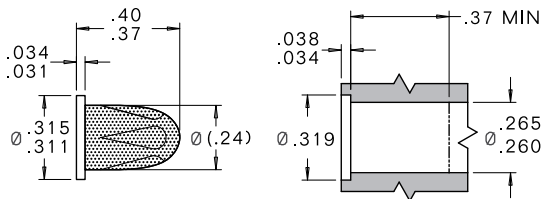

312 FLANGE MOUNT SCREEN

Lee Part Numbers	Hole Size in.	Open Area in. ²	Total Area in. ²	No. of Holes	Burst Press. psid	Collapse Press. psid	ROB [†] No.	Lohm ^{††} Rate
FSJA3120047A	.004	.11	.37	9000	1250	250	9.5	40
FSJA3120067A	.006	.11	.37	4000	2600	550	20	40
FSJA3120087A	.008	.10	.37	2000	3150	800	34	40
FSJA3120157A	.015	.15	.37	850	2750	800	247	40

375 FLANGE MOUNT SCREEN

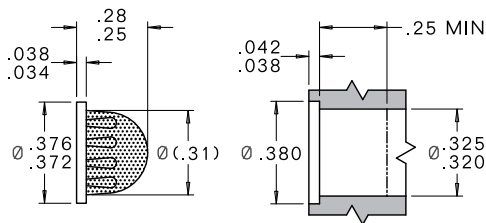

Lee Part Numbers	Hole Size in.	Open Area in. ²	Total Area in. ²	No. of Holes	Burst Press. psid	Collapse Press. psid	ROB [†] No.	Lohm ^{††} Rate
FSJA3750047A	.004	.09	.30	7500	1150	250	8	20
FSJA3750067A	.006	.10	.30	3500	2050	850	18	20
FSJA3750087A	.008	.09	.30	1800	2300	950	30	20
FSJA3750157A	.015	.11	.30	620	2050	950	180	20

500 FLANGE MOUNT SCREEN

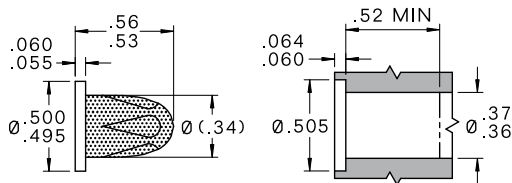

Lee Part Numbers	Hole Size in.	Open Area in. ²	Total Area in. ²	No. of Holes	Burst Press. psid	Collapse Press. psid	ROB [†] No.	Lohm ^{††} Rate
FSJA5000047A	.004	.23	.78	18300	1450	100	19	18
FSJA5000067A	.006	.25	.78	8840	2650	300	45	18
FSJA5000087A	.008	.19	.78	3800	3150	350	64	18
FSJA5000157A	.015	.32	.78	1810	2950	400	527	18

656 FLANGE MOUNT SCREEN

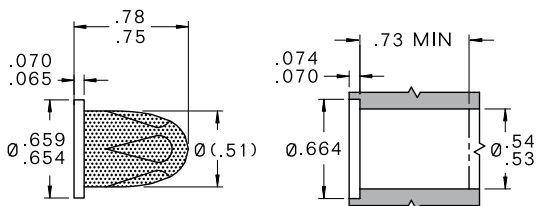

Lee Part Numbers	Hole Size in.	Open Area in. ²	Total Area in. ²	No. of Holes	Burst Press. psid	Collapse Press. psid	ROB [†] No.	Lohm ^{††} Rate
FSJA6560047A	.004	.51	1.7	40500	1250	100	43	8
FSJA6560067A	.006	.54	1.7	19100	1750	165	97	8
FSJA6560087A	.008	.41	1.7	8150	2250	450	138	8
FSJA6560157A	.015	.71	1.7	4000	1750	350	1164	8

† The ROB (Resistance to Blockage) factor is a system of rating the relative resistance to blockage of safety screens. The higher the ROB number, the more resistance to blockage.

†† The Lohm is a measure of flow resistance. Example: One Lohm will permit a flow of 100 GPM of water at 25 psid at 80°F. Additional information can be found at www.TheLeeCo.com or contact your Lee Sales Engineer for more information.