

LPM INERT SOLENOID PUMP

The Lee Company's new LPM Series Inert Solenoid Pump is the latest addition to Lee's line of fixed volume solenoid pumps. In response to the ever increasing demands of the medical and scientific industries, this new pump was designed to offer greater design flexibility and significant cost savings.

The LPM pump features a revolutionary port head design that allows tubing connections and manifold mounting. This enables the designer to test the fluidic system using connections to soft 1/16" tubing, and then once the system design has been finalized, the same pump can be manifold mounted using standard O-rings.

The electrical interface of the LPM Inert Solenoid Pump features a contoured end cap that provides secondary connector retention and is compatible with standard AMP® connectors. The Lee Company offers compatible lead wire sets in two different lengths:

- 6" lead wire set: LSWX0504300A
- 24" lead wire set: LSWX0606700A

Available in standard 10 µL and 25 µL models the LPM Series Pump offers low power consumption, repeatability and long life.

Request Lee drawing LPMA0350000B for product details.

- Low Power Consumption: 1.5 Watts
- 12 or 24 Volt Operation
- Speed: 5 Hz (7.5 mL/minute max.)
- Fluidic Interface: 1/16" Tubing or Manifold Mount
- End Cap with Electrical Connector Retention
- Standard Dispense Volumes (±1.5 µL):
25 µL Dispense per Shot
10 µL Dispense per Shot
- Self-priming



- Wetted Materials:
Housing: PEEK
Elastomer: FKM or EPDM
- Small Footprint
- Integrated Check Valves

PART NUMBER	VOLUME (µL)	ELASTOMER	VOLTAGE (vdc)
LPMA1250625L	25	FKM	12
LPMA2450625L	25	FKM	24
LPMA1251625L	25	EPDM	12
LPMA2451625L	25	EPDM	24
LPMA1250110L	10	FKM	12
LPMA2450110L	10	FKM	24
LPMA1251110L	10	EPDM	12
LPMA2451110L	10	EPDM	24

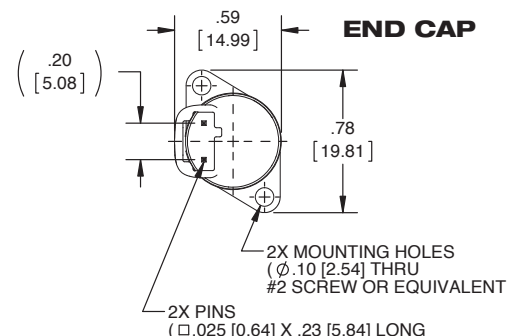
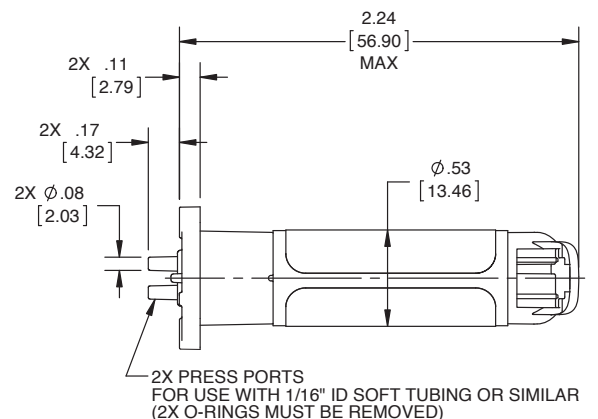
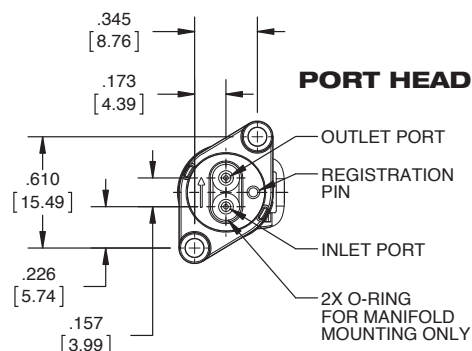
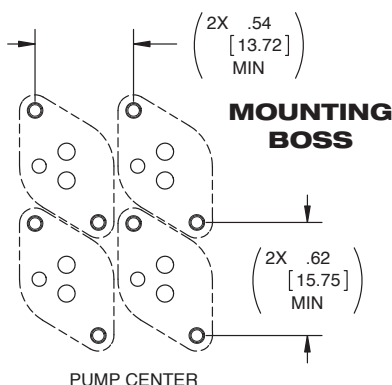

Reference Drawing Number LSIX1001470A for Boss Details.

LPM 1-PLACE MANIFOLD ADAPTERS

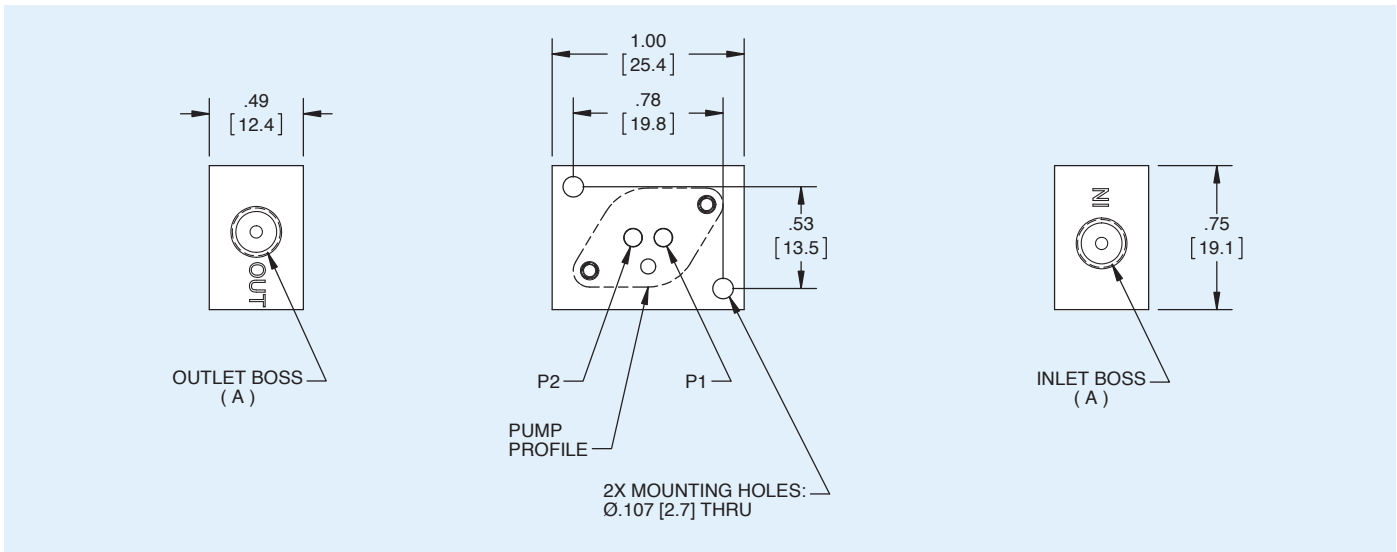

PART NUMBER	PORTS (A)	MATERIAL
LSMX0517510B	062 MINSTAC	PEEK
LSMX0517520B	062 MINSTAC	PMMA
LSMX0517410B	1/4-28	PEEK
LSMX0517420B	1/4-28	PMMA

Adaptor manifolds are available for design prototyping. This allows the fluidic system to be designed, built up and tested, all prior to manifold construction. The same LPM Pump can later be used on the manifold system.

Reference Drawing Number LSMX0517500B for 062 MINSTAC and LSMX0517400B for 1/4-28

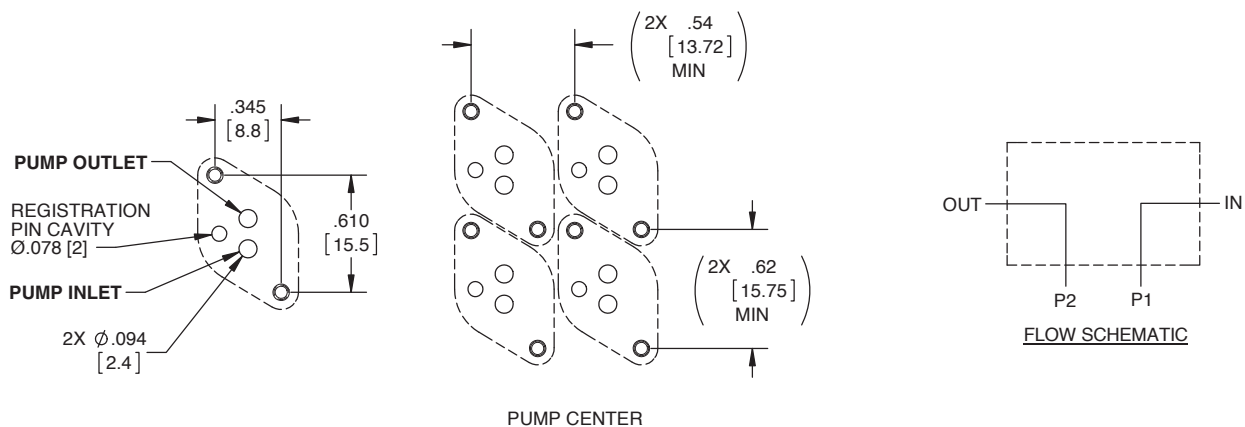

Reference Drawing Number LSIX1001470A for Boss Details.

The LPM Inert Solenoid Pump is just one part of The Lee Company's complete line of precision fluid control products that includes miniature solenoid valves, micro dispense valves and nozzles, integrated manifolds and other precision fluid handling components. The Lee Company's extensive research facilities and experienced teams of

engineers keep the company at the forefront of fluid control technology. In addition, Lee maintains an international network of sales engineers ready to assist you in solving your fluid control problems. For more information, contact a Lee Sales Engineer today, or visit www.theleeco.com.