

# Weld End Fittings

## BS4825-2, Swept Tee

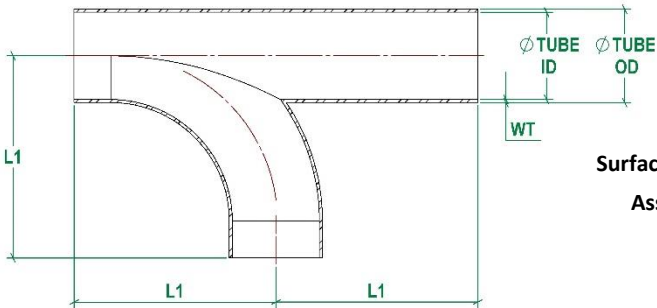

**Standard:** BS4825-2, Imperial OD

**Material:** 316 Stainless Steel, EN1.4401

**Certification:** EN 10204-3.1

**Surface Finish (Ext / Int):** Dull Polish

**Associated Standard:** BS4825-1, BS4825-3, BS4825-4, BS4825-5

**Associated Parts:** OD Tube, TC Ferrule, Hygienic Unions

**Options:** Non Standard Versions Can Be Pulled

**Remarks:**

### Weld End Fittings, BS4825-2, Swept Tee

Size (inch)	TUBE OD (mm)	TUBE ID (mm)	WT (mm)	L1 (mm)	L2 (mm)	Part Code
1.000"	25.40	22.10	1.65	65.00	130.00	WTS.BS.0100.6P
1.500"	38.10	34.80	1.65	85.00	170.00	WTS.BS.0150.6P
2.000"	50.80	47.50	1.65	110.00	220.00	WTS.BS.0200.6P
2.500"	63.50	60.20	1.65	135.00	270.00	WTS.BS.0250.6P
3.000"	76.20	72.00	1.65	155.00	310.00	WTS.BS.0300.6P
4.000"	101.60	97.60	2.00	195.00	390.00	WTS.BS.0400.6P

Published Data Is Given in Good Faith. We Reserve the Right To, Without Warning Change the Dimensions When Not In Conflict With The Published Standard

#### Flowsource Process Fittings

Unit 2F Hockney Road Industrial Estate, West Yorkshire, BD8 9HQ, United Kingdom  
 [T] 01535 274 316 - [e] sales@flowsourcepf.com - [w] www.flowsourcepf.com

**FLWSOURCE**  
**PROCESS FITTINGS**