

ACCESSORIES - CONTENTS

CONNECTION AND EXTENSION CABLES **80-82**



PC CONNECTION CABLES

CONVERTER CABLES / T-JUNCTION BOX **83-85**



SERVICE CABLES **86**



SIMULATORS **87**



MOUNTING HARDWARE **87-88**

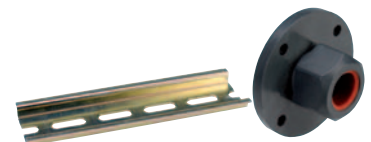

DESKTOP STANDS / CARRY CASES **89-91**



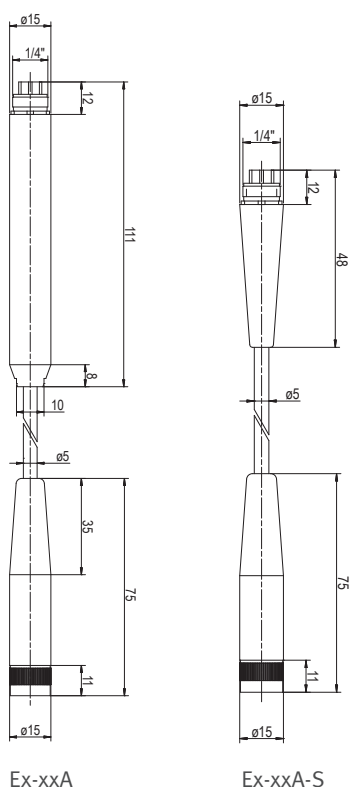

HC2 PROBE EXTENSION CABLES

for transmitters / handheld instruments / data loggers

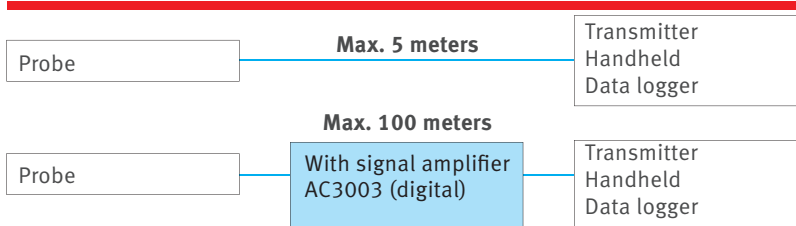

Features

- Range of application -40...90 °C
- 30 cm type to place probe away from instruments with self-heating

HC2 probe extension cables

Order code	Color	Shaft	Cable length	
E2-F3A	Black	Normal	30 cm	
E2-01A			1 m	
E2-02A			2 m	
E2-02A-S			Short [S]	2 m
E2-05A			Normal	5 m
E3-F3A	White	Normal	30 cm	
E3-01A			1 m	
E3-02A			2 m	
E3-02A-S			Short [S]	2 m
E3-05A			Normal	5 m

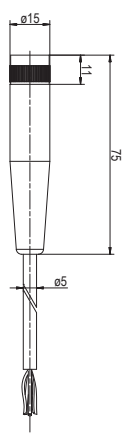

CABLES to connect an analog probe to a HP23-A, HF8, HL-NT

Features

- Range of application -40...70 °C
- Open ends

Cables to connect an analog probe to a HP23-A, HF8, HL-NT

Order code	Color	Cable length
A-01XX	Black	1 m
A-02XX		2 m
A-05XX		5 m

HC2 CONNECTOR

Features

- Maximum wall thickness: 4 mm
- Hole diameter: 12.5 mm
- 30 cm long, color-coded wires
- Ends tin-plated
- Range of application: -40...100 °C

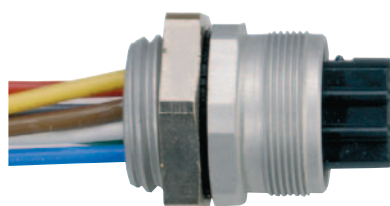

Order code	E2-XX
------------	-------

EXTENSION CABLES with open ends

Order code	Color	Shaft	Length	Range of application
Supply voltage 3.3 VDC (without voltage regulator)				
E2-01XX	Black	Normal	1 m	-40...90 °C
E2-02XX			2 m	
E2-02XX-S		Short [S]	2 m	
E2-05XX		Normal	5 m	
E2-05XX-S		Short [S]	5 m	
E3-01XX	White	Normal	1 m	
E3-02XX			2 m	
E3-05XX			5 m	
Supply voltage 5...24 VDC / 5...16 VAC (with voltage regulator)				
E2-01XX-ACT/01	Black	Normal	1 m	-40...70 °C
E2-02XX-ACT/01			2 m	
E2-05XX-ACT/01			5 m	
E3-01XX-ACT/01	White	Normal	1 m	
E3-02XX-ACT/01			2 m	
E3-05XX-ACT/01			5 m	
Supply voltage 5...40 VDC / 6...28 VAC (with voltage regulator)				
E2-01XX-ACT-HV	Black	Normal	1 m	-40...70 °C
E2-02XX-ACT-HV			2 m	
E2-05XX-ACT-HV			5 m	
Wire assignment				
Green	VDD (+)	3.3 VDC		
		5...24 VDC / 5...16 VAC		
		5...40 VDC / 6...28 VAC		
Gray	GND	Digital and power supply GND		
Red	RXD	UART		
Blue	TXT	UART		
White	Out1	Analog output 1, standard humidity 0...100 %RH = 0...1V		
Brown	Out2	Analog output 1, standard temperature -40...60 °C = 0...1V		
Yellow	AGND	Analog GND		

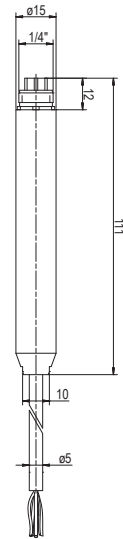

E2-01xx

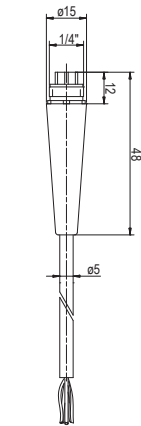

E2-02xx-S

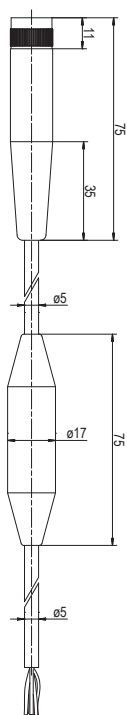

AC3003L
With long shaft

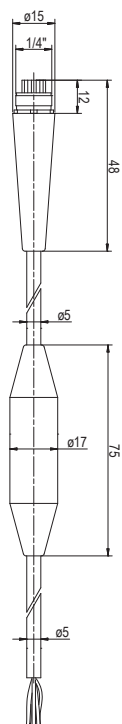

AC3003

DIGITAL SIGNAL AMPLIFIERS

Features

- Color: black
- Range of application: -40...70 °C
- Power supply: 3.3 V / 4.8 mA

Digital signal amplifiers

Order code	Description	Cable length / Shaft
AC3003	UART signal amplifier, probe and instrument side with luster terminals	Normal shaft
AC3003-L	UART signal amplifier, probe and instrument side with luster terminals	Long shaft [L]
AC3003-Cable-D	Cat. 5 cable S/FTP wire	100 m
AC3003-Cable-L	Cat 5. cable S/FTP «stranded wire»	100 m
AC3003/10	AC3003 with luster terminals and	10 m
AC3003/20	preassembled	20 m
AC3003/50	cat. 5 cable, normal shaft	50 m
AC3003/80		80 m
AC3003/100		100 m

SERVICE CABLE HF TRANSMITTER

Features

- Transfer of measured values from HP22/23 to HF3/4/5/7/8
- USB-Mini to 7-pin connector

Service cable HF transmitter

Order code	Description
AC2001	Service cable HF transmitter

USB CONVERTERS for HC2 probes

Features

- To connect HC2 probes to a PC via the USB interface
- Requires HW4 software on the PC
- Power supply via USB interface
- Range of application: -40...70 °C
- Cable length: 2.8 m

USB adapters for HC2 probes

Order code	Description	Shaft
AC3001	Active UART to	Short shaft
AC3001-L	USB converter cable	Long shaft [L]
XD-AC3001	Active UART to USB converter cable for XD probes	Short shaft

AC3001

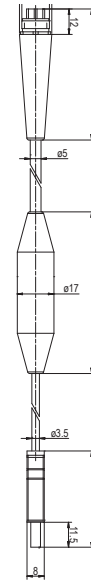

AC3001-L

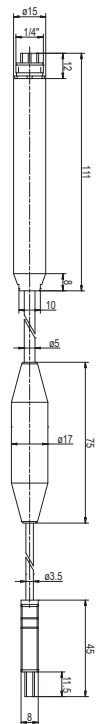

USB CONVERTERS with open ends for HC2 probes

Features

- To connect HC2 probes (with open ends) to a PC via the USB interface
- Requires HW4 software on the PC
- The probe requires a separate power supply (5...24 VDC / 5...16 VAC)
- Cable length: 2.8 m
- Range of application: -40...70 °C

USB adapter for HC2 probes

Order code	Description
AC3001-XX	Active UART to USB converter cable, open ends (incl. luster terminal)

AC3001-XX

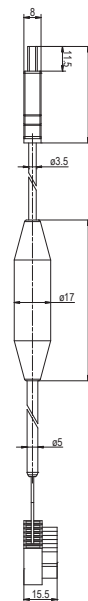

RS-232 CONVERTERS for HC2 probes

Features

- To connect HC2 probes to a PC via the RS-232 interface
- Requires HW4 software on the PC (power supply 9 V, AC adapter AC1207 must be ordered separately)
- Range of application: -40...70 °C

RS-232 adapter for HC2 probes

Order code	Description	Cable length
AC3002	Active UART to RS-232 converter cable	2.8 m
AC1207	AC adapter 9 V	

AC3002

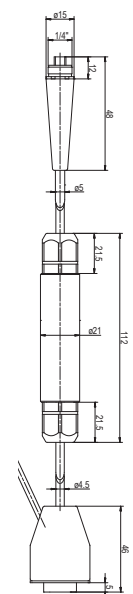

ETHERNET CONVERTER for HC2 probes

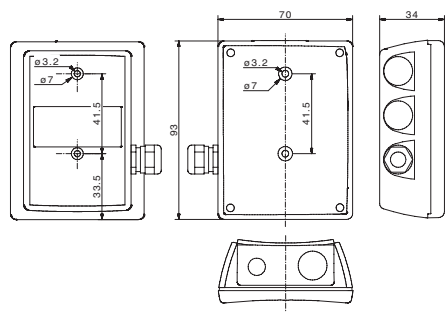

Features

- To connect HC2 probes to a PC via Ethernet interface
- Requires HW4 software on the PC
- Power supply via AC adapter (order separately)
- Range of application: -40...70 °C

Ethernet adapter for HC2 probes

Order code	Description	Cable length
AC3005	UART ↔ Ethernet	35 cm
AC1207	AC adapter 9 V	

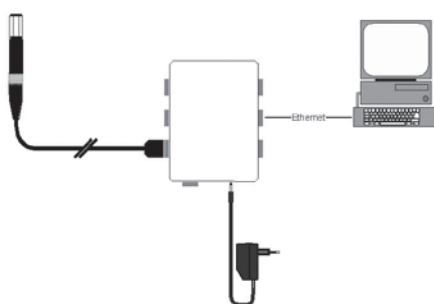

Power supply via AC adapter

RS-485 AND MODBUS CONVERTER

for HC2 probes

Features

- To connect HC2 probes to a RS-485 or Modbus network
- It is possible to switch between Modbus and RS-485 protocol in the HW4 software
- Power supply: 5...28 VDC
- Range of application: -40...70 °C

Self-heating of the adapter can lead to errors in the measured values; it is therefore advisable to place the probe a short distance away with an extension cable (e.g. E2-F3A).

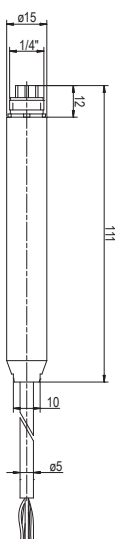

RS-485 / Modbus adapters

Order code	Description	Cable length
E2-01XX-MOD	Adapter cable for HC2	1 m
E2-02XX-MOD	RS-485 and MODBUS	2 m
E2-05XX-MOD		5 m

RS-485 / USB CONVERTER

Features

- Compatible with HF456, HF53x, HF54x, HF55x with digital interface
- Power supply via USB interface
- Acts in a RS-485 network as slave
- Range of application: -40...70 °C
- Cable length: 1 m

RS-485 ↔ USB converter

Order code	Description
AC3010	RS-485-USB converter

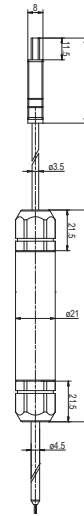

ETHERNET / RS-485 CONVERTER

Features

- Compatible with all HF4 to HF8 with a RS-485 interface, HL-NT
- Enables connection of up to 64 RS-485 slaves to an Ethernet network
- Has an IP address, but no RS-485 address, not considered as a RS-485 device
- Range of application: -40...70 °C
- Current consumption: 85 mA

Requires an external 12-24 VDC power supply. The power supply can simultaneously be used to supply the connected RS-485 devices.

Ethernet / RS-485 converter

Order code	Description
AC3011	RS-485 Masterbox



RS-485 T-JUNCTION BOX

Features

- Passive RS-485 T-junction box
- For simple installation of RS-485 networks
- Wall mounting
- 240 Ohm terminator, connectable via jumper
- Range of application: -40...70 °C

RS-485 T-junction box

Order code	Description
AC3021	RS-485 T-junction box



SERVICE CABLES for HF, HP21 / 22, HL-20

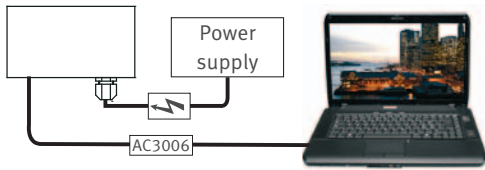

AC3006

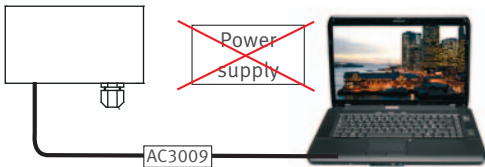

AC3009



AC3006 / AC3009

Features

- Connects ROTRONIC instruments via their service interface (UART) to a USB interface
- Compatible with HF3, HF4, HF5, HF7, HF8, HP21 and HP22, HL-20(D)
- Requires HW4 software
- For programming (settings, scaling, firmware update, etc.) of compatible instruments
- Two different types:
AC3006, the instrument must be supplied with power
AC3009, the instrument is supplied with power via the USB interface

AC3006 in combination with a 2-wire type: with all 2-wire types (HF320, HF420, HF520, HF620, HF720, XB20) ensure that the computer or laptop is galvanically isolated from the main power supply.

Service cable

Order code	Description
AC3006	Service cable without power supply
AC3009	Service cable with power supply via USB interface

SERVICE CABLE for HP23-A / HP23-AW-A / HF1 / TF1

Features

- Requires HW4 software
- For programming (settings, re-scaling, firmware update, etc.)

Service cable for HP23-A / HP23-AW-A

Order code	Description	Length
AC0003	USB-A to USB-Mini cable	1.8 m



SERVICE CABLE for HL-NT

Features

- Connects HL-NT docking station to a PC
- Requires HW4 software
- For programming (settings, scaling, firmware update, etc.) of HL-NT loggers

Service cable for HL-NT docking station

Order code	Description	Length
AC0002	Standard USB A/B cable	1.8 m



HC2 SIMULATORS

Features

- Humidity / Temperature simulators with fixed values and certificate
- For system validation
- Values cannot be changed with the HW4 software
- Range of application: -40...100 °C

HC2 simulators

Order code	Humidity	Temperature
HC2-SIMC-000/0023	0 %RH	23 °C
HC2-SIMC-035/0023	35 %RH	
HC2-SIMC-050/0023	50 %RH	
HC2-SIMC-080/0023	80 %RH	
Other types available on request		



PROTECTIVE CAPS

Features

- Protects probes/connectors during cleaning cycles against water and chemical substances, e.g. H2O2

Protective caps

Order code	Protects
Protection-E2/E3	Connectors
Protection-Filter	Sensor
Protection-HC2	Complete HC2



Protection-E2/E3



Protection-Filter



Protection-HC2

MOUNTING KIT FOR DIN TOP-HAT RAILS

Mounting kit for DIN top-hat rails

Order code	Description
AC5002	DIN top-hat rail adapter for PF4, HF4, HF5, HF8, AC3011 (2 pc.)
AC5002 DIN 120	Top-hat rail 120 mm long (PF4, HF4 and HF5, AC3011)
AC5002 DIN 180	Top-hat rail 180 mm long (HF56x, HF8)

AC5002

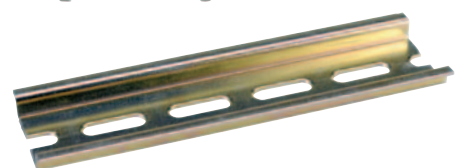

MOUNTING GLAND WITH FLANGE for temperatures < 100 °C



Mounting gland	
Order code	Description
AC5005	Mounting flange for 15 mm probe

MOUNTING GLANDS / MOUNTING FLANGE for temperatures <100 °C / >100 °C



Mounting gland



Mounting flange

Mounting glands / Mounting flange for temperatures >100 °C				
Order code	Dimensions	Material	Gasket	Temperature
Mounting gland for 15 mm probe				
AC1303-M	M20 x 1.5	Brass, nickel-plated	Viton	To 200 °C
AC1305-M	M25 x 1.5	Brass, nickel-plated	TPE	To 100 °C
Mounting gland for 25 mm probe				
AC1304-M	M32 x 1.5	Brass, nickel-plated	Viton	To 200 °C
Mounting gland for 15 mm ATEX probe				
AC1301-MEX	M25 x 1.5		Buna-N/FPM	To 95 °C
Mounting flange				
AC1305 for AC1303-M				
AC1306 for AC1304-M				
AC1307 for AC1305-M				
AC1305	Ø 80 mm	Steel, nickel-plated	-	To 200 °C
AC1306			-	
AC1307			-	

HYGROCLIP HOLDERS for 15 / 25 mm



AC1319

AC1320

HygroClip holders	
Order code	Description
AC1319	Ø 15 mm, gray
AC1320	Ø 25 mm, gray

DESKTOP STAND

for HygroPalm HP21 – HP23-A / TP22

Features

- Desktop stand for the handheld instruments HP21, HP22(-A), HP23(-A), HP-23-AW(-A), TP22
- Also works with the TP22 and HygroPalm 1 to 3 (old series)

Desktop stand for HygroPalm HP21 – HP23-A / TP22

Order code	Description
DESK-HP	Desktop



UNIVERSAL DESKTOP STAND

for HygroPalm HP21 – HP23-A / HygroLog HL-NT

Features

- Desktop stand for the handheld instruments HP21, HP22(-A), HP23(-A), HP23-AW(-A) and HL-NT loggers with docking station
- Set contains a clip for mounting of the HygroPalm
- Set contains screws for mounting of the docking station to the desktop stand

Desktop stand for HygroPalm HP21 – HP23-A / HygroLog HL-NT

Order code	Description
DESK-NT	Desktop stand



CARRY CASES

ROTRONIC case inserts are specially designed for the safe transport of ROTRONIC instruments and accessories. Cases from third parties can destroy the sensors (through chemical emissions).

CARRY CASE HP22-(A) / HP23-(A)



Features

- Cutouts for:
 - 1x HygroPalm HP22-(A) or HP23-(A)
 - 2x standard probes HC2-S/S3
 - 1x handheld probe (excl. HC2-HK40/42)
 - 1x calibration device ER-15
 - 1x pack humidity standards
 - 1x 9 V battery
 - 1x extension cable probe <-> handheld instrument (max. 2 m)
 - 1x instruction manual
- Can also be used for the HygroPalm 1/2/3 and HygroClip S.
- Dimensions: 450 x 360 x 140 mm (outer)

Order code: AC1126

CARRY CASE HP21 / HP22-(A) / HP23-(A)



Features

- Cutouts for:
 - 1x HygroPalm HP21, HP22-(A) or HP23-(A)
 - 2x standard probes HC2-S/S3
 - 1x calibration device ER-15
 - 1x pack humidity standards
 - 1x CD-ROM
 - 1x 9 V battery
 - 1x instruction manual
 - Cutout for extension cable
- Can also be used for the HygroPalm 1/2/3 and HygroClip S
- Dimensions: 395 x 300 x 105 mm (outer)

Order code: AC1127

CARRY CASE AW



Features

- Cutouts for:
 - 1x HygroPalm HP23-A or HP23-AW-A
 - 1x water activity measurement probe HC2-AW
 - 1x sample holder WP-40 or WP-14-S
 - 4x ampoules (humidity standard)
 - 1x set textile pads
 - 1x 9 V battery
 - 13x sample containers PS-14 or 6x PS-40
 - 1x instruction manual
- Dimensions: 395 x 300 x 105 mm (outer)

Order code: AC1124

CARRY CASES

CARRY CASE GTS

Features

- Cutouts for:
 - 1x GTS
 - 1x calibration device EGS
 - 1x pack humidity standards
 - 1x 9 V battery
 - 1x battery charger
 - 1x mini screwdriver
- Dimensions: 450 x 365 x 135 mm (outer)

Order code: AC1102



CARRY CASE S1

Features

- Cutouts for:
 - 1x handheld instrument with sword probe S1
 - 1x calibration device EGS
 - 1x pack humidity standards
 - 1x 9 V battery
 - 1x AC adapter
 - 1x mini screwdriver
 - 1x manual
- Dimensions: 395 x 295 x 106 mm (outer)

Order code: AC1115



UNIVERSAL CARRY CASE SMALL

Features

- Universal case with resilient protective foam
- Dimensions: 395 x 300 x 105 mm (outer)

Order code: AC1123



UNIVERSAL CARRY CASE LARGE

Features

- Universal case with resilient protective foam
- Dimensions: 450 x 360 x 140 mm (outer)

Order code: AC1125

