

fp fp fp fp fp fp fp fp fp fp fp fp fp fp fp fp

Instructions

Chair Pressure Mat - (PMC)

FREQUENCY PRECISION®

airlert®

www.pressuremat.com

A pressure-sensitive mat to alert to chair Leaving

The Airlert™ Chair Pressure Mat alerts as soon as someone gets out of a chair. The mat can be positioned above or below the seat cushion depending on the type of chair.

What's Inside

Your bed pressure mat is supplied either to plug into your existing call system (Plug-Matched) or wirelessly linked to our pagers (Pager-Linked). Each consists of a square foam mat and a battery powered control box. These plug together using the black airtube. The Plug-Matched package will also contain a matched lead to connect into your call system.



Chair Pressure Mat

Control Box

How it works

The air-filled pressure mat is placed on the chair (ideally under the cushion though it can be on top) and is connected to the control box. As someone gets out of the chair the reduction in air pressure in the pressure mat is detected by the control box. The red light on the control box turns on and the alert is triggered.

Control box attaches to chair



Installation Instructions

1 Insert the mat into position on the chair. Lift up the chair cushion and insert the pressure mat ensuring the airtube is free to connect to the control box. If the cushion is fixed then the mat can sit on top. We suggest fixing it with velcro stickers or our non-slip mat.

2 Plug in and set the control box.

Jack socket



For **Plug-Matched** sensors the control box is plugged into the call system using the supplied cable.



For **Pager-Linked** systems, this socket provides an additional socket for an optional call bell or floor pressure mat.

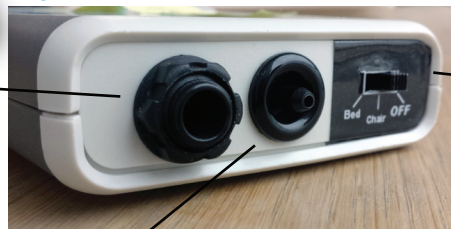

Socket to connect Air pipe from mat

Plug the airtube from the mat in by sliding the end firmly over the proud airpipe. Ensure it is not bent or crushed to allow clear airflow.



Control Switch

This switch turns the control box on and sets it to monitor either a bed or chair mat. Make sure it is switched to 'Chair'. *Your control box can do both Bed and Chair sensing. Additional mats can be purchased from us.*

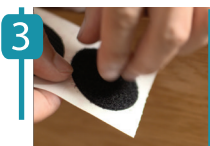

Check the batteries are in place in the compartment on the back of the control box before positioning it on the chair. This can be done using the supplied velcro sticker or optional holder and strap. The strap can wrap around the chair leg or frame.

call 01837 810 590

fp fp fp fp fp fp fp fp fp fp fp fp fp fp fp fp

Problem Solving

Connections

It sounds simple but it is important to check all the plugs and tubes are plugged in correctly. The jack plugs need to be plugged all the way in.

Sensitivity

Our mats are supplied with a preset level of sensitivity. It is possible that from time to time you might need to increase the sensitivity if the mat is used by a very lightweight person. To drastically increase the sensitivity the box can be switched to the 'BED' position. For a more subtle change it is also possible to try reducing the amount of air in the mat by unplugging the airtube and applying pressure before re-attaching. Alternatively the control box can be returned to us for adjustment.

Mat inflation

If your mat is not working correctly try letting it inflate before inserting the airtube and putting it into position.

It can also help to do the following:

1. allow the mat to inflate unplugged on the floor.
2. Plug the airtube into the control box,
3. Finally place it under the cushion (ensuring it remains plugged in to keep the air in).

Mat position

Where you position the mat effects how the alert is triggered. Moving the mat further back in the chair speeds up the alert and moving it further forward slows it down.

Low Battery

Check that the battery in the control box is not flat. Try replacing the battery with 2x new AA Alkaline batteries. We recommend Duracell Alkaline batteries. We can supply these at trade prices. Contact us for details.

Control Box Switch

Check that the switch on the control box has not accidentally been set to 'Bed' or 'Off'.



PAGER-LINKED

Control Box Coding (Pager-linked Only)

Check the ID sticker on the front of the control box. It should correspond to the pager that you have. If you are having problems and you have a large, complex system it is possible that the control box is linked to a different pager. This is indicated through a colour coding system. For example, a yellow ID sticker means it is linked to a pager with a yellow sticker.

Other Information

Cleaning

The mat contains no batteries or electronics since it is air operated. It can therefore be cleaned with detergent or mild chlorine solution as required. We suggest wiping with a disposable cloth using alcohol solvent, disinfectant or with warm soapy water. The black air tube can be removed at both ends and wiped as above or as a low cost item these may be replaced easily. The control box and pager receiver incorporate electronic components and should not be submerged but may be wiped with an alcohol solvent, detergent or mild chlorine solution as required.

Safety

Remember, daily system tests should be carried out to ensure correct function of the unit. Usage should be incorporated within safety manuals and procedures. Range tests should be carried out at least once a week, more often if critical criteria apply. This should involve testing the unit past its required range. If the unit has been dropped or it is worn by a person involved in an accident the unit should be tested again before re-use.

Care

DO NOT subject this equipment to: Mechanical shock, Excessive humidity, Extremes of temperatures, Corrosive Liquids.

This equipment is designed primarily for indoor use and is not water resistant. It must not be used in classified hazardous areas including areas containing explosive or flammable vapours. Consult your local product dealer for further information.

Specifications:

Control box - pager-linked:

Power supply	2x AA Alkaline Battery (Removable, not rechargeable)
Frequency	433.92MHz
Bit Rate	1200 - 7uV/M
Code format	POCSAG
Dimensions (pager-linked):	147mm x 88mm 25mm

Control box - plug-matched:

Power supply	2x AA Alkaline Battery (Removable, not rechargeable)
Dimensions (plug-matched):	117mm x 78mm 24mm
Weight with battery	140g

Chair Mat:

Dimensions(mm)	400mm(L)x 300mm(W) x 35mm(thickness)
Weight	170g

Compliance:

R&TTE Directive 1999/5/EC
EMC Directive(89/336/EEC) EN 301 489 -1 V 1. 4. 1
Low Voltage Directive (7323/EEC) EN60950 : 2000
ETSI EN 300 220-1 V2 (2006 – 04)
ROHS II compliant

Liability

Frequency Precision does not accept any liability for any damage or injury, howsoever caused as a result of misuse of this equipment. It is the responsibility of the user to ensure that the equipment is operated in the manner for which it was intended and that it is the correct item of equipment for the required task.

All systems can fail and it is the responsibility of the user to carry out regular tests and to determine the suitability of this equipment for any application.

Repair and replacement

Frequency Precision will refund payment for any unit returned within 30 days of purchase as unsuitable for the intended purpose. Un-damaged units will be repaired free of charge within the first 12 months.

Literature

Frequency Precision Ltd operates a policy of continual improvement and therefore reserves the right to modify and change any specification without prior notice.

While every possible care has been taken in the preparation of its manual, we do not accept any liability for the technical or typographical errors or omissions contained herein, nor for incidental or consequential damages arising from the use of the material.

Disposal

At the end of the working life of the product it must not be disposed of with household waste but returned to Frequency Precision Ltd or disposed of at a collection point for the re-cycling of electrical and electronic equipment.