



Disabled Persons Toilet Alarm Kit

This battery powered kit meets the requirements for emergency signalling systems for disabled persons. It is fully compliant with BS8300 and the Disability Discrimination Act.

Everything is provided in the kit (except cable and fixings) to deliver an effective, fully compliant, simple to install and simple to use system.

To generate a call the user simply pulls the pull cord. When the call is generated an audible and visual warning is given at both the toilet area and at the Aidalarm controller which can, if required, be located away from the toilet possibly in a reception area. The call can be muted at the controller by pressing the button at the centre of the four LEDs. This will cause the Aidalarm to bleep every 50 seconds as a warning of non attendance to reception. The audible indications at the toilet area will bleep every five seconds to re-assure the caller. The system can only be reset at (or near) the point of call using the Reset Button. The system is entirely battery powered and as such avoids any conflict with Part P building regulations.

The controller is powered by 6 AA Alkaline batteries which should last more than 12 months in normal use.

The system provides a low battery warning.

- DDA & BS8300 Compliant
- Controller with High Power Piezo Sounder
- Four selectable Warning Tones
- Powered by 6 AA Alkaline batteries
- Low battery warning
- Audible & Visual Signalling to remote point
- Ceiling Pull Cord with LED
- Pull Cord Instruction Label with Braille
- Reset Button with LED, Sounder & Braille
- Overdoor Audible Visual Indication
- Optional Dado Panic Strip or Call Buttons
- Mains powered version (A600LKITM) available

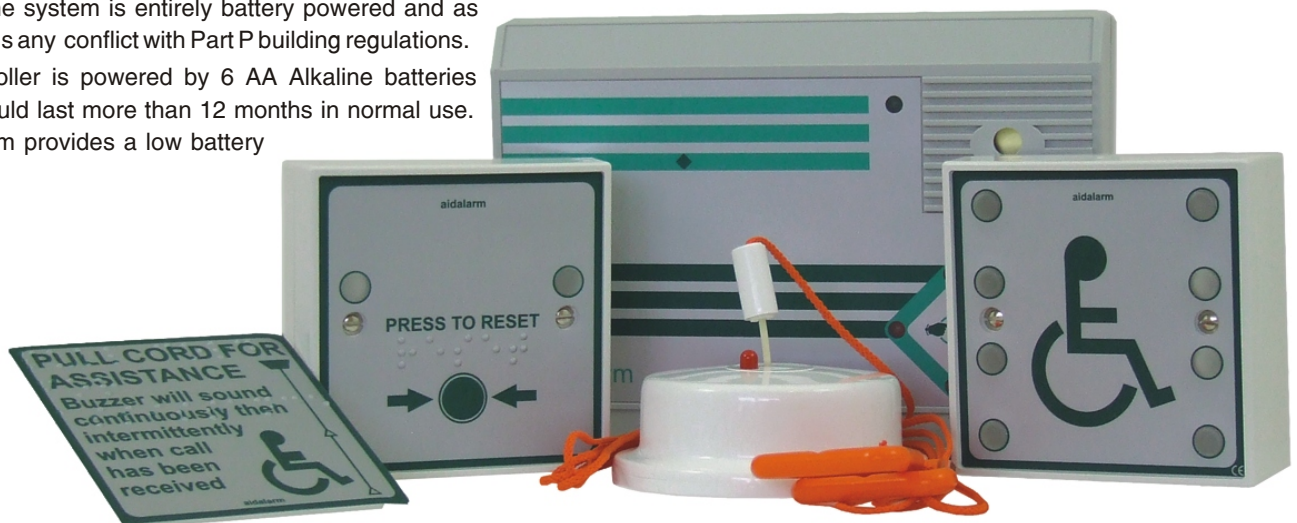

The kit (part no. A600LKITB) includes:

- 1 x A600B battery powered Aidalarm controller
- 1 x S1600 Pull cord with re-assurance LED
- 1 x LAB35107 Pull Cord instruction label with braille
- 1 x S1708A Aidalarm Reset button with re-assurance LED, sounder and braille
- 1 x S1778A Aidalarm Overdoor light and sounder
- 6 x 1.5v AAA Alkaline batteries
- Cable and fixing clips are NOT included
- Optional accessories such as Dado Panic Strip or Press to Call push buttons can be added to suit local requirements

