



The Right Connection™

Petroleum, Drybulk and FloTech Overfill Prevention



Dixon Group Europe Ltd

Dixon House, 350 Leach Place, Walton Summit Centre, Preston PR5 8AS, UK

Telephone: +44 (0)1772 323529

Fax: +44 (0)1772 314664 Email: enquiries@dixoneurope.co.uk

www.dixoneurope.co.uk

API Valves

Used for bottom loading/unloading of petroleum tankers.

Available Options:

- Ergonomic handle to allow manual operation
- Load only and load/unload valves
- Sight glass & flow indicator
- Fixed/Removable handle
- Baylast/Teflon seals

Seals can be replaced without the need to remove from the tanker.
Plastic and metal dust caps are available for the API valves.



Gravity Drop Adapter

Dixon manufacture two styles of gravity drop adapter.

Standard one piece design

- Quality cast aluminium
- Buna/Viton seal options
- Bronze cam arm with stainless steel pins and finger rings
- Optional sight glass

Two piece bolt together design with sight glass

- Consists of a ring assembly and an outlet which contains mounting balls, sight glass and seals

Both styles available 3" – 4".

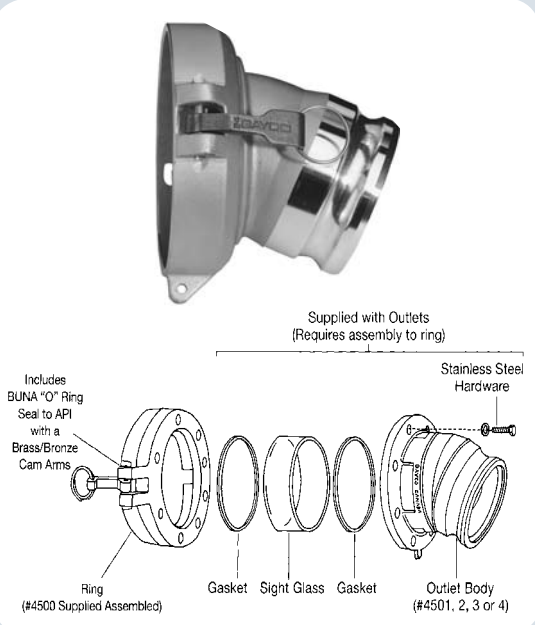

Dry Disconnect Adapters

A Bayco dry disconnect adapter helps prevent spillage from normal or accidental disconnects.

Features:

- 2 piece adapter for easy rebuilding
- Interchangeable with Kamvalok™ style fittings
- Aluminium fittings have aluminium nose piece and brass piston

Size: 2" – 4"

Thread: NPT or BSP connections.

Material: Aluminium or stainless steel.

Seal: Various materials.

Must be used with Bayco style coupler for adapter to operate.



Vapour Return Valve

- Heavy duty cast aluminium body
- 4" adapter with or without poppet valve, FNPS, FNPT or round TTMA connection
- air interlock mount

Vapour caps available in Nylon and Aluminium complete with built in locking feature, centred T handle, colour coded orange for safety, hole for a chain/lanyard.

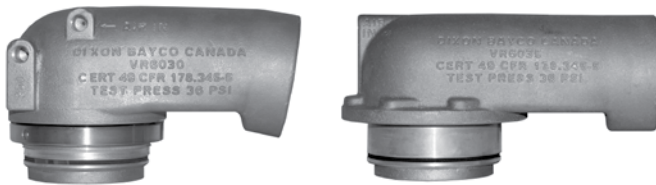

Sequential Vapour Vents

- Used for venting tank vapours during the bottom loading and unloading of petroleum tankers
- These can be installed to either 16" or 20" tank manholes

Dry Disconnect Couplers

- Heavy duty stainless steel crank and link
- Stainless steel handle allows exposure to corrosive chemicals or washdown service
- Fully interchangeable with Kamvalok™ style fittings
- Stainless steel internal
- Dixon EZ Boss-Lock cam arms provide high security from accidental opening on 1½" and 2" fittings
- Large EZ Boss-Lock paddle type cam arms allow for easy grip on 3" fittings

Size: 1½" – 4"
Thread: NPT or BSP connections
Material: Aluminium or stainless steel
Seal: Various materials

Must be used with Bayco style adapter for coupler to operate.



Ball Nozzles for Bulk Delivery

- Uses a full port ball valve for high flow rate
- The internal flow path is designed to provide low pressure drop across the nozzle. Lower pressure drop permits higher flow rates at lower pressure
- Reduces foaming and backups

Our unique swivel design permits low temperature operation without leakage around the O-ring seals. The swivel freely rotates at temperatures as low as -40°C and pressures as high as 7 Bar / 100 PSI.

Hardened chrome steel roller balls and hardened carbon steel ball race provide long service life.

FloTech Overfill Prevention Products

Overfill Prevention Probes

The FloTech 2 & 5 wire optic overfill prevention probes are manufactured in accordance with EN13922.

- They feature a unique prism sealing design that prevents product and vapour entering the electronics and causing probe failure
- Probes are available in 7", 12" & 18" lengths
- Fully compatible with installed industry standard rack monitors



ATEX Approved Thermo Optic Sensors



Overfill Prevention Sockets

- Socket options include 6 pin, 3 J slot for 5 wire systems and 10 pin, 4 J slot for 2 wire systems
- Sockets can include a brake interlock to prevent drive away, vapour recovery interlock or both

FloTech sockets use a patented detachable nose ring that permits replacement without the need to disconnect the wiring.

Replacement Parts

Dixon offer a complete range of replacement parts for your overfill systems.

- Sockets allow for the transfer of the electronic signal from the terminal control monitor to the tanker. Sockets will vary depending upon terminal equipment
- Aluminium Wear Rings available with a range of options



Composite Hose Assemblies

Dixon offers a range of anti static suction and discharge composite hose assemblies designed for use on plant or road/rail tankers.

Hose construction is exceptionally flexible for ease of handling yet remains robust, hard wearing and cost effective.

A comprehensive range of fittings and hose assembly service is available.