

Meeting Room Tables

38mm thick worktops in madrona burr and maple veneer with 5mm wide tulipwood inlay band and power & data access flap.



Flip-top style polished chrome base with underside in sapele mahogany veneer.



"The timescale we were working to put Clarke Rendall under immense pressure from day one. They handled it without a word of complaint and delivered on every front. I can't praise them highly enough"

Facilities Manager, Fasken Martineau

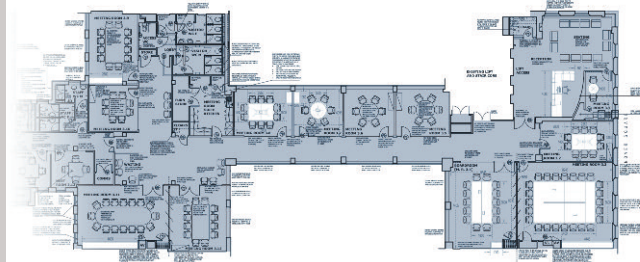

Located in Hanover Square, Central London, International Business Law and Litigation Firm **Fasken Martineau** had outgrown their fourth floor offices, expanding into the third floor that would house all meeting rooms in one area. With a need for any new furniture to suite in perfectly with existing tables, Fasken Martineau appointed office furniture and refurbishment specialists **WiseBuy Furniture** to assist with the project.

Confident they could deliver the quality this project demanded, **WiseBuy MD, Julian Sheldrake** called in **Clarke Rendall** to produce the bespoke 12 section madrona burr veneer flip top table and 4 stand-alone meeting room tables required; along with several other joinery items and a stunning 4m long crown cut cherry veneer monolithic design reception counter.

A dedicated and successful advocate of networking, Julian commented *"I only work with companies who offer me a quality service, because if my client is this impressed with the results, it's going to generate more business for me"*.

Production of all furniture from first contact through initial design concepts to approved working drawings, manufacture and final installation had to be implemented within an eight week build programme and Fasken Martineau **Facilities Manager Garry Burdett** was **delighted** and even surprised at just how **efficient, reliable** and **professional** Clarke Rendall were at every stage, stating, *"Our contract manager did not believe that with the timescale we were working to, Clarke Rendall would be able to deliver - but they certainly did!"*

To be sure this kind of service will deliver YOU such impressive results with YOUR next project, call our support team now on **01908 391600** or visit our comprehensive [website](#).

Clarke ■ Rendall

Bringing furniture design to life

Head Office: 01908 391600 • London: 020 7781 2162
salesupport@clarkerendall.com • www.clarkerendall.com

Conference Room Table 1.8m x 0.9m - 12 off

30mm thick worktops in madroha burr and maple veneer with 5mm wide tulipwood inlay band and access flap to mild steel power & data enclosure.

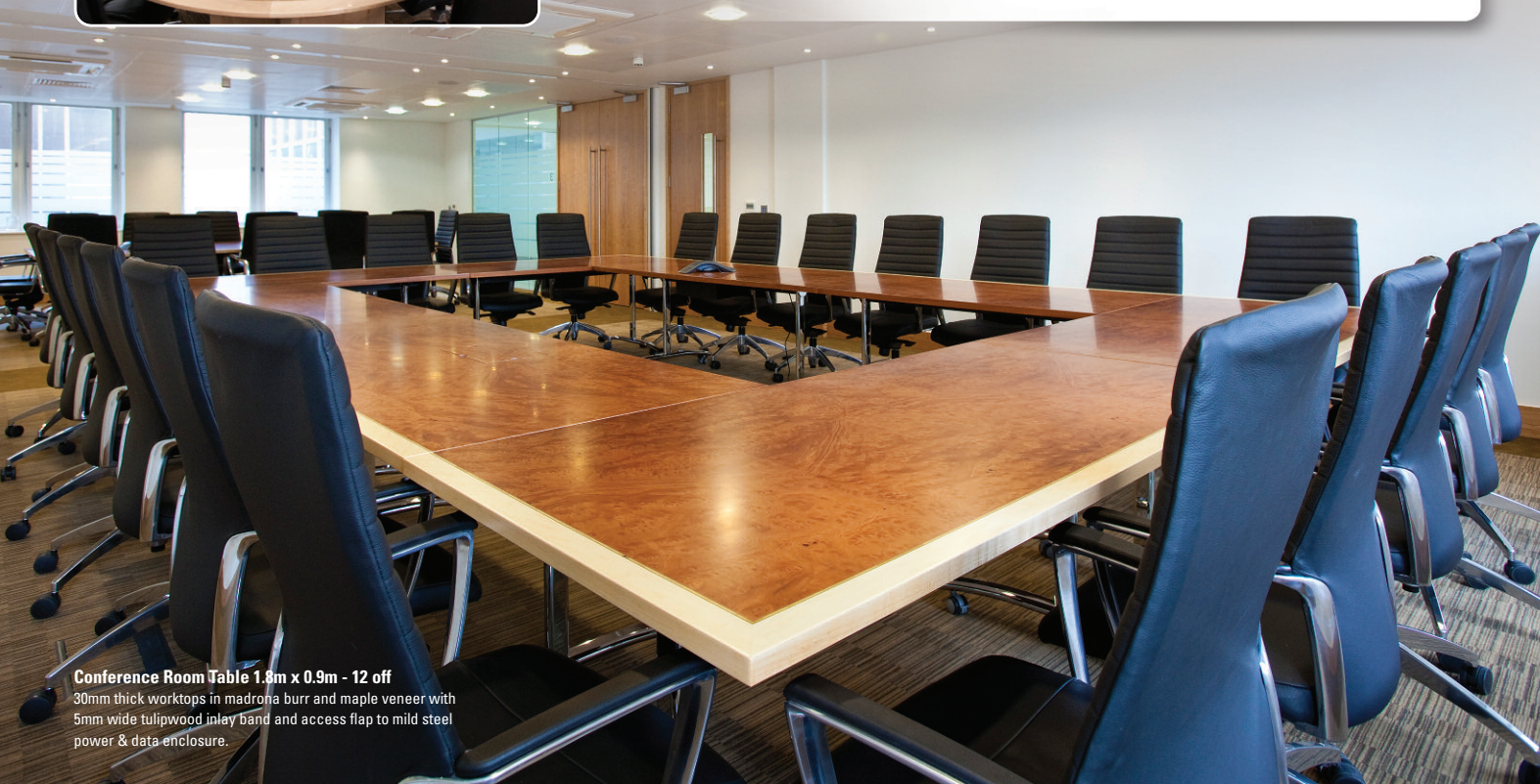

"I deal with Clarke Rendall because they share my professionalism and my commitment to delivering a quality service and a quality product"

Managing Director, WiseBuy Furniture



Crown-cut cherry veneer finish to suite with elevator access wall panelling



10mm thick clear toughened glass counters on satin aluminium posts



Reception Desk

4m long counter in crown-cut cherry veneer finish with brushed aluminium finish recessed inlay bands and recessed plinth with integral LED lighting

Clarke Rendall's contribution to the project

- Main reception desk
- 12 off 1.8m x 0.9m section 'flip-top' racecourse table
- 2.8m x 1.4m meeting table
- 2.4m x 1.7m meeting table
- 1.5m Ø circular table
- 1m Ø circular table
- 2 off bespoke worktops
- 3 off bespoke credenzas



Bringing furniture design to life

Head Office: 01908 391600 • London: 020 7781 2162
 salesupport@clarkerendall.com • www.clarkerendall.com