



Media Wall
4.2m concave curve fascia with feature pelmet finished throughout in tobacco aida walnut laminate with black laminate feature inlay strips



Break out area table
4.3m serpentine shaped table top and base unit finished in matt white laminate with white PVC edging



Reception Desk
4.1m curved tobacco aida walnut laminate desk with sandblasted glass counter caps

"I've known Clarke Rendall for probably fifteen years, and I knew I'd get the quality I wanted - It's as simple as that"

Envoplan

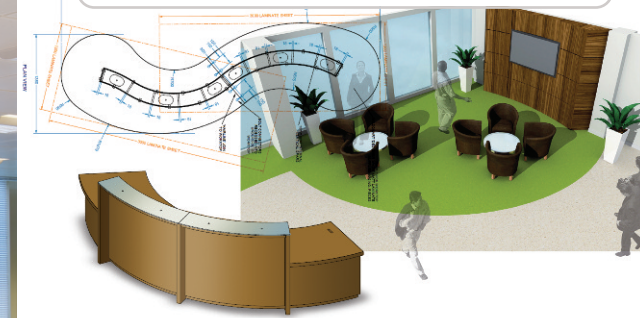

Project: **Iron Mountain**

Business Area: **Commercial/Office**

Nowhere is the capacity to work as part of a team more crucial than in the area of office interior refurbishment - a key factor in **Envoplan** Sales Director **Graham Robertson's** decision to call on **Clarke Rendall** to play an important role in this project. Commissioned to produce a curved walnut reception desk, suited media wall and large bespoke break out area table, Graham knew he could rely on Clarke Rendall to **deliver his vision for his client**, global records management and data protection specialists **Iron Mountain**. *"This particular project was of ultimate importance to me. I had to be sure it would be done right first time"* he explained, *"and I have complete confidence that with Clarke Rendall, I'll get exactly what I want"*.

Envoplan put forward several options for the design of the main reception area and the design team at **Clarke Rendall** worked diligently to take the final approved concept and deliver a high quality, functional, durable counter that brought the design to life.

The walnut media wall that faces the desk was a more straight forward element to the scheme, altering very little from the initial design, and is typical of the type of ancillary bespoke joinery item that Clarke Rendall regularly produce. As too was the 4.3m long bespoke serpentine table taking pride of place in one of the break out areas.

This was another successful project, with the client *"extremely happy with the quality and standards delivered by Clarke Rendall"* and inspiring Graham to use language such as *"great"*, *"fantastic"* and even *"absolutely awesome!"*

For more information on how you can deliver this level of satisfaction to **YOUR** clients, call our support team now on **01908 391600** or visit our comprehensive website.

