



# Modulo Slimline

BEHIND THE  
MIRROR SYSTEM



**WASHROOM**  
ACCESSORIES



**DUDLEY**  
**INDUSTRIES**

SHEET METAL EXPERTISE SINCE 1942

# Modulo Slimline

## BEHIND THE MIRROR SYSTEM



**WASHROOM**  
ACCESSORIES

Good design makes a critical difference to the usability and management of a washroom.

A good design needs to take into consideration the needs of both visitors and maintenance teams alike.

An effective hand hygiene system needs to be reliable, robust and easy to use and service. In addition, it needs to meet the demands placed on your washroom.







## Key Benefits



### Modulo Slimline for users:

- › Dispensers are positioned where needed
- › Easy to use
- › Touch free operation
- › Reliable



### Modulo Slimline for facility managers

- › Robust to minimise maintenance time
- › Easy to install
- › Confidence with up to 10 years' warranty
- › Choice of dispenser positions
- › Reduces slip hazards by keeping drips over basins



### Modulo Slimline for maintenance and cleaning teams

- › Fewer drips on the floor
- › Large capacity
- › Easy to refill
- › Reliable
- › Spare consumable storage
- › Locked to protect consumables



### Modulo Slimline for designers

- › Compact design
- › Utilises the wall space above basins
- › Removes obstacles to maximise available space
- › Space saving yet stylish solution
- › Robust and reliable recommendation

# Bespoke solutions for your washroom space.

## Cabinets

Choose from 600mm or 1200mm wide cabinets.

- › Manufactured in stainless steel for durability
- › Powder coated in stylish matte black
- › Mirrored glass door supported by gas struts for ease of opening
- › Lockable to protect contents and dispensers
- › Easy to clean
- › Choice of dispenser locations
- › Integrated shelf for spare consumables

Cabinets can be installed on their own or combined to fill wider spaces.

The cabinets provide a choice of dispenser locations to ensure you can position dispensers where you need them.

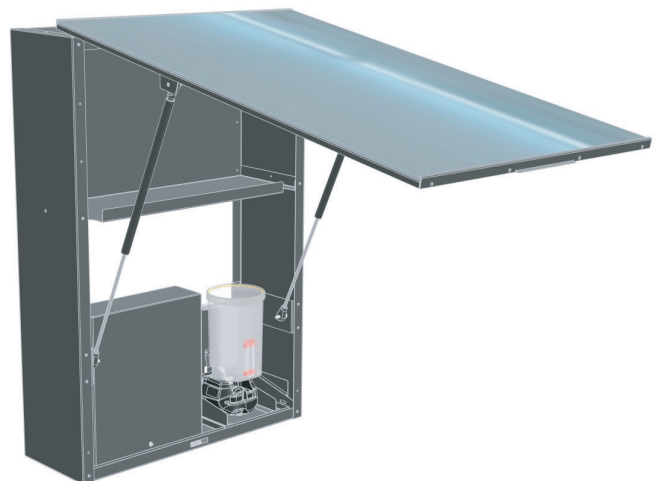
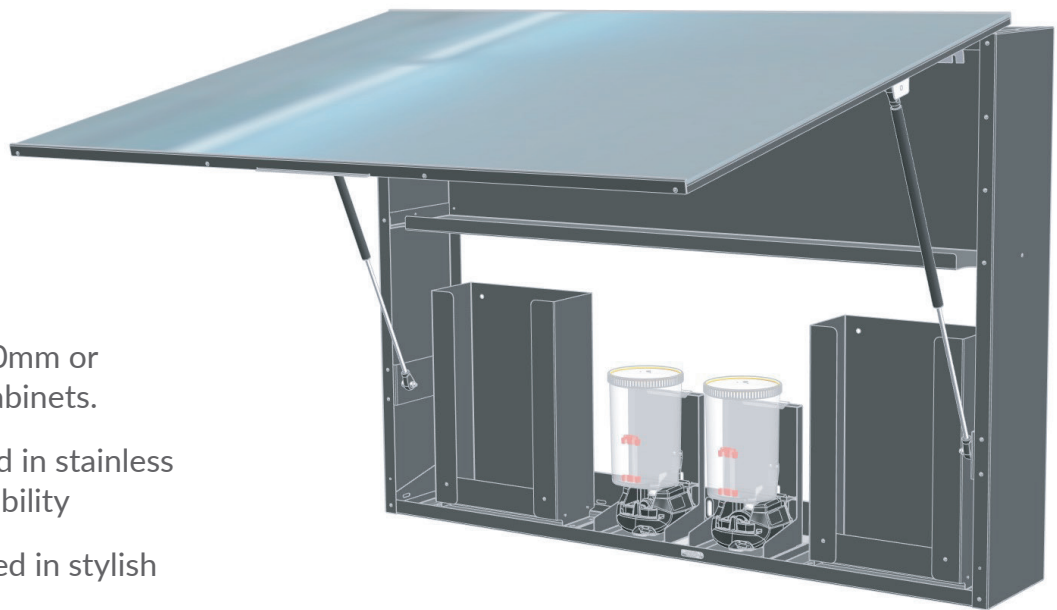

### BESPOKE SOLUTION

If combinations of 600mm don't quite fill your available space, bespoke filler cabinets can be made to your exact requirements.

*Speak to our team to discuss further.*

# Dispensers

- › 2L AUTO SOAP
- › PAPER TOWEL DISPENSER
- › HAND DRYER

## PRODUCT HIGHLIGHTS:

### 2L Auto Soap

- › Touch free operation
- › Reservoir suitable for your choice of liquid soap
- › Large capacity for busy washrooms and less time spent refilling
- › Battery operated or mains powered options available



### Paper Towel Dispenser

- › Large capacity
- › Easy to refill
- › Simple design reduces potential for blockages



### Hand Dryer

- › Touch free operation
- › Energy efficient
- › Quiet operation
- › Reduces washroom waste



# Easy to install:

## Cabinet

Simply attach the wall brackets to the wall, hang the cabinet and fix into place.

## Dispensers

The standard base plate allows the dispensers to be positioned in multiple locations, ensuring that they are where users need them.

The base plate sits over the locator pins and is fixed into place with the nuts provided.

Available for specification at:



**bimobject**<sup>®</sup>

Product Code	Product Description	Material	Finish	Size (H x W x D)
92400BK	2L Auto Soap Dispenser (battery operated)	Stainless steel and mixed materials	Matte black powder coat	293 x 193 x 173mm
92401BK	2L Auto Soap Dispenser (mains powered)	Stainless steel and mixed materials	Matte black powder coat	293 x 193 x 173mm
92402BK	Paper Towel Dispenser	Stainless steel	Matte black powder coat	413 x 388 x 173mm
92403BK	Hand Dryer	Stainless steel and mixed materials	Matte black powder coat	328 x 388 x 173mm
92406BK	Cabinet 1200mm	Stainless steel and mixed materials	Matte black powder coat / Mirror	960 x 1200 x 230mm
92407BK	Cabinet 600mm	Stainless steel and mixed materials	Matte black powder coat / Mirror	960 x 600 x 230mm
92408BK	Blanking Plate (double)	Stainless steel	Matte black powder coat	15 x 360 x 175mm
92409BK	Blanking Plate (single)	Stainless steel	Matte black powder coat	15 x 195 x 175mm



## WARRANTY INFORMATION

**10**  
YEARS  
WARRANTY

Cabinets  
Blanking Plates  
Soap Dispenser  
Paper Towel Dispenser

**3**  
YEARS  
WARRANTY

Hand Dryer

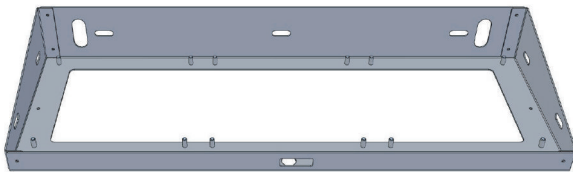
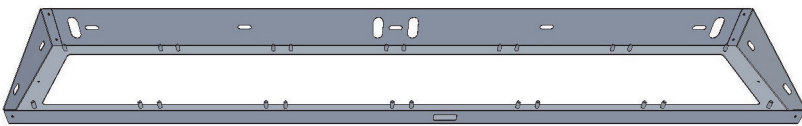

## Designing your own cabinet?

Modulo Slimline is available as a shelf only system for designers and installers building bespoke cabinets.

The shelf system attaches to the wall or back panel of the cabinet and provides the same choice of fixing positions as the cabinet.

Product Code	Product Description	Material	Finish	Size (H x W x D)
92405BK	Shelf Only 600mm	Stainless steel	Matte black powder coat	75 x 596 x 212mm
92404BK	Shelf Only 1200mm	Stainless steel	Matte black powder coat	75 x 1198 x 212mm





## The environmental choice:

We believe the best way to reduce waste is to design products that last a long time, decades even. And classic, timeless designs never go out of fashion.

But there is more to our products than just their reliability. Did you know that stainless steel is made up of 60% recycled content? And that stainless steel can be re-cycled countless times without any loss of quality.

## The hygienic choice:

All Modulo Slimline dispensers require no touch to operate.

Our soap dispenser and hand dryer use infra-red technology to detect hands underneath and to trigger operation. Our paper towel dispenser presents the next multi-fold towel so visitors only need to touch the towel they intend to use.

The dispensers are easy to clean but with the added protection of the cabinet keeping them free from splashes, finger prints and dust so minimal cleaning is required.

With its mirrored glass front, the cabinet is easy to clean.

## Dudley Industries, experts in hand hygiene dispensers since 1942.

We have over 80 years of experience in designing and manufacturing washroom dispensers, so you're in good hands.

All our dispensers are designed by our team of engineers and made on site at our Lancashire factory. From here, we serve a global market and our products can be found in the most prestigious addresses around the world.



Sales: +44 (0)1253 738 311

Dudley Industries Ltd  
Preston Road  
Lytham-St-Annes  
Lancashire  
FY8 5AT

Email: [sales@dudleyindustries.com](mailto:sales@dudleyindustries.com)  
Web: [www.dudleyindustries.com](http://www.dudleyindustries.com)

